

**SILVERTHIN JSA025CP0****2.5 in Sealed Type C Thin Section Bearing****Specifications**

Bore (B)	2.500 in
Outside Diameter (D)	3.000 in
Width	1/4"
Land Diameter (L <sub>1</sub> )	2.686 in
Land Diameter (L <sub>2</sub> )	2.814 in
Approximate Weight	0.12 lbs
Separator	Brass; snapover separator
Precision Class	ABEC Class 1
Bearing Type	Radial Contact (Type C)
Seals, Shields	Buna N Rubber Seal
Unit System	Inch

**Load Capacities**

Static Radial Load	830 lbf
Dynamic Radial Load	440 lbf
Torque Max No Load	8 in-lbs

**Interchange**

Silverthin	<a href="#">JSA025CP0</a>	Kaydon	<a href="#">JA025CPO</a>	Kaydon	<a href="#">JA025CPO</a>	INA	<a href="#">CSCA0252RS</a>
SKF	<a href="#">FPCA2082RS1</a>	FAG	<a href="#">L10QA2082RSD</a>	NSK	<a href="#">NBC06306DD</a>	NTN	<a href="#">KRA063LL</a>
SSB	<a href="#">RJA025CP0</a>						

**Brass; snapover separator**

1/8" balls

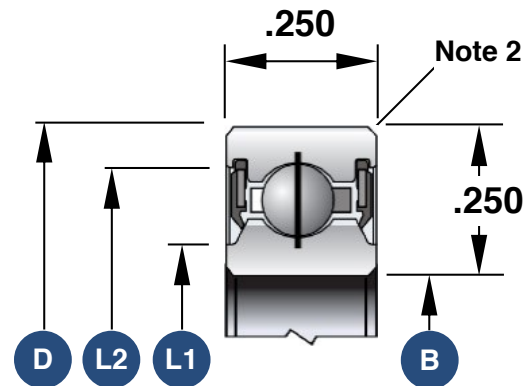

1. Load capacities are not additive
2. The maximum shaft or housing fillet radius that the bearing corners will clear for this series is 0.025"
3. Race Width Tolerance: +0.000 -0.005"

**Also Available**

Open Angular Contact	<a href="#">SA025AR0</a>
Open Radial Contact	<a href="#">SA025CP0</a>
Open 4-Point Contact	<a href="#">SA025XP0</a>
Sealed 4-Point Contact	<a href="#">JSA025XP0</a>
Open Duplexed (Back-to-Back)	<a href="#">SA025BR0</a>
Open Duplexed (Face-to-Face)	<a href="#">SA025FR0</a>