

**SILVERTHIN JSA035CPO****3.5 in Sealed Type C Thin Section Bearing****Specifications**

Bore (B)	3.500 in
Outside Diameter (D)	4.000 in
Width	1/4"
Land Diameter (L <sub>1</sub> )	3.686 in
Land Diameter (L <sub>2</sub> )	3.814 in
Approximate Weight	0.17 lbs
Separator	Brass; snapover separator
Precision Class	ABEC Class 1
Bearing Type	Radial Contact (Type C)
Seals, Shields	Buna N Rubber Seal
Unit System	Inch

**Load Capacities**

Static Radial Load	1,140 lbf
Dynamic Radial Load	530 lbf
Torque Max No Load	16 in-lbs

**Interchange**

Silverthin	<a href="#">JSA035CPO</a>	Kaydon	<a href="#">JA035CPO</a>	Kaydon	<a href="#">JA035CPO</a>	INA	<a href="#">CSCA0352RS</a>
SKF	<a href="#">FPCA3082RS1</a>	FAG	<a href="#">L10QA3082RSD</a>	NSK	<a href="#">NBC08806DD</a>	NTN	<a href="#">KRA088LL</a>
SSB	<a href="#">RJA035CPO</a>						

**Brass; snapover separator**

1/8" balls

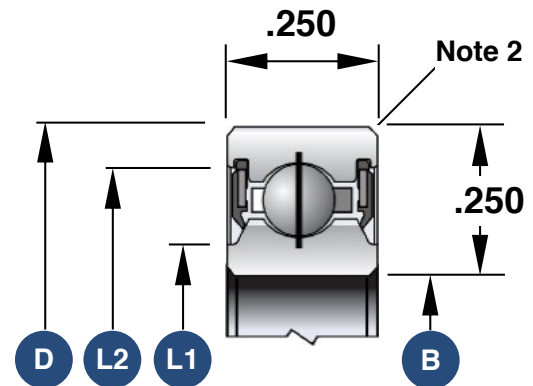

1. Load capacities are not additive
2. The maximum shaft or housing fillet radius that the bearing corners will clear for this series is 0.025"
3. Race Width Tolerance: +0.000 -0.005"

**Also Available**

Open Angular Contact	<a href="#">SA035AR0</a>
Open Radial Contact	<a href="#">SA035CPO</a>
Open 4-Point Contact	<a href="#">SA035XPO</a>
Sealed 4-Point Contact	<a href="#">JSA035XPO</a>
Open Duplexed (Back-to-Back)	<a href="#">SA035BR0</a>
Open Duplexed (Face-to-Face)	<a href="#">SA035FR0</a>