

SILVERTHIN JSA040CP0**4 in Sealed Type C Thin Section Bearing****Specifications**

Bore (B)	4.000 in
Outside Diameter (D)	4.500 in
Width	1/4"
Land Diameter (L ₁)	4.186 in
Land Diameter (L ₂)	4.314 in
Approximate Weight	0.19 lbs
Separator	Brass; snapover separator
Precision Class	ABEC Class 1
Bearing Type	Radial Contact (Type C)
Seals, Shields	Buna N Rubber Seal
Unit System	Inch

Load Capacities

Static Radial Load	1,290 lbf
Dynamic Radial Load	570 lbf
Torque Max No Load	20 in-lbs

Interchange

Silverthin	JSA040CP0	Kaydon	JA040CPO	Kaydon	JA040CPO	INA	CSCA0402RS
SKF	FPCA4002RS1	FAG	L10QA4002RSD	NSK	NBC10106DD	NTN	KRA101LL
SSB	RJA040CP0						

Brass; snapover separator

1/8" balls

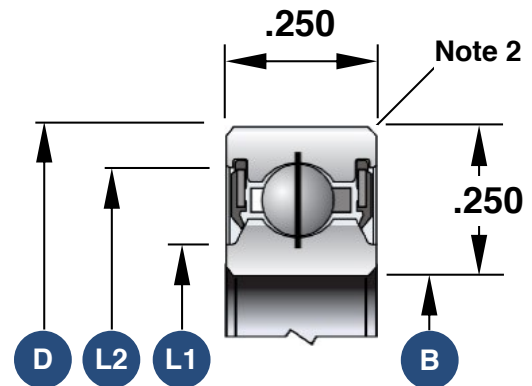

1. Load capacities are not additive
2. The maximum shaft or housing fillet radius that the bearing corners will clear for this series is 0.025"
3. Race Width Tolerance: +0.000 -0.005"

Also Available

Open Angular Contact	SA040ARO
Open Radial Contact	SA040CPO
Open 4-Point Contact	SA040XPO
Sealed 4-Point Contact	JSA040XPO
Open Duplexed (Back-to-Back)	SA040BR0
Open Duplexed (Face-to-Face)	SA040FR0