

**SILVERTHIN JSA042XPO****4.25 in Sealed Type X Thin Section Bearing****Specifications**

Bore (B)	4.250 in
Outside Diameter (D)	4.750 in
Width	1/4"
Land Diameter (L <sub>1</sub> )	4.436 in
Land Diameter (L <sub>2</sub> )	4.564 in
Approximate Weight	0.20 lbs
Separator	Brass; snapover separator
Precision Class	ABEC Class 1
Bearing Type	4-Point Contact (Type X)
Seals, Shields	Buna N Rubber Seal
Unit System	Inch

**Load Capacities**

Static Radial Load	1,370 lbf
Dynamic Radial Load	785 lbf
Static Thrust Load	3,410 lbf
Dynamic Thrust Load	1,260 lbf
Static Moment Load	3,070 in-lbs
Dynamic Moment Load	1,320 in-lbs
Torque Max No Load	24 in-lbs

**Interchange**

Silverthin	<a href="#">JSA042XPO</a>	Kaydon	<a href="#">JA042XPO</a>	Kaydon	<a href="#">JA042XPO</a>	INA	<a href="#">CSXA0422RS</a>
SKF	<a href="#">FPXA4042RS1</a>	FAG	<a href="#">L18QA4042RSD</a>	NSK	<a href="#">NBX10706DD</a>	NTN	<a href="#">KXA107LL</a>
SSB	<a href="#">RJA042XPO</a>						

**Brass; snapover separator**

1/8" balls

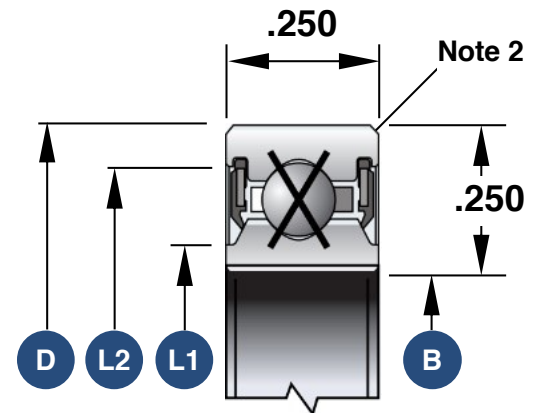

1. Load capacities are not additive
2. The maximum shaft or housing fillet radius that the bearing corners will clear for this series is 0.025"
3. Race Width Tolerance: +0.000 -0.005"

**Also Available**

Open Angular Contact	<a href="#">SA042AR0</a>
Open Radial Contact	<a href="#">SA042CP0</a>
Open 4-Point Contact	<a href="#">SA042XPO</a>
Sealed Radial Contact	<a href="#">JSA042CP0</a>
Open Duplexed (Back-to-Back)	<a href="#">SA042BR0</a>
Open Duplexed (Face-to-Face)	<a href="#">SA042FR0</a>