

SILVERTHIN JSA045CP0**4.5 in Sealed Type C Thin Section Bearing****Specifications**

| | |
|---------------------------------|---------------------------|
| Bore (B) | 4.500 in |
| Outside Diameter (D) | 5.000 in |
| Width | 1/4" |
| Land Diameter (L ₁) | 4.686 in |
| Land Diameter (L ₂) | 4.814 in |
| Approximate Weight | 0.21 lbs |
| Separator | Brass; snapover separator |
| Precision Class | ABEC Class 1 |
| Bearing Type | Radial Contact (Type C) |
| Seals, Shields | Buna N Rubber Seal |
| Unit System | Inch |

Load Capacities

| | |
|---------------------|-----------|
| Static Radial Load | 1,440 lbf |
| Dynamic Radial Load | 610 lbf |
| Torque Max No Load | 28 in-lbs |

Interchange

| | | | | | | | |
|------------|-----------------------------|--------|------------------------------|--------|----------------------------|-----|----------------------------|
| Silverthin | JSA045CP0 | Kaydon | JA045CPO | Kaydon | JA045CPO | INA | CSCA0452RS |
| SKF | FPCA4082RS1 | FAG | L10QA4082RSD | NSK | NBC11406DD | NTN | KRA114LL |
| SSB | RJA045CP0 | | | | | | |

Brass; snapover separator

1/8" balls

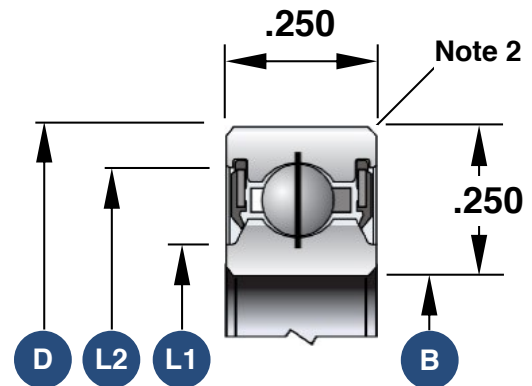

1. Load capacities are not additive
2. The maximum shaft or housing fillet radius that the bearing corners will clear for this series is 0.025"
3. Race Width Tolerance: +0.000 -0.005"

Also Available

| | |
|------------------------------|---------------------------|
| Open Angular Contact | SA045AR0 |
| Open Radial Contact | SA045CP0 |
| Open 4-Point Contact | SA045XP0 |
| Sealed 4-Point Contact | JSA045XP0 |
| Open Duplexed (Back-to-Back) | SA045BR0 |
| Open Duplexed (Face-to-Face) | SA045FR0 |