

SILVERTHIN JSA055CP0**5.5 in Sealed Type C Thin Section Bearing****Specifications**

Bore (B)	5.500 in
Outside Diameter (D)	6.000 in
Width	1/4"
Land Diameter (L ₁)	5.686 in
Land Diameter (L ₂)	5.814 in
Approximate Weight	0.25 lbs
Separator	Brass; snapover separator
Precision Class	ABEC Class 1
Bearing Type	Radial Contact (Type C)
Seals, Shields	Buna N Rubber Seal
Unit System	Inch

Load Capacities

Static Radial Load	1,750 lbf
Dynamic Radial Load	685 lbf
Torque Max No Load	44 in-lbs

Interchange

Silverthin	JSA055CP0	Kaydon	JA055CP0	Kaydon	JA055CP0	INA	CSCA0552RS
SKF	FPCA5082RS1	FAG	L10QA5082RSD	NSK	NBC13906DD	NTN	KRA139LL
SSB	RJA055CP0						

Brass; snapover separator

1/8" balls

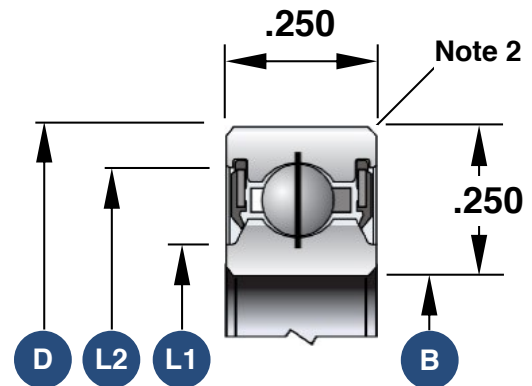

1. Load capacities are not additive
2. The maximum shaft or housing fillet radius that the bearing corners will clear for this series is 0.025"
3. Race Width Tolerance: +0.000 -0.005"

Also Available

Open Angular Contact	SA055AR0
Open Radial Contact	SA055CP0
Open 4-Point Contact	SA055XP0
Sealed 4-Point Contact	JSA055XP0
Open Duplexed (Back-to-Back)	SA055BR0
Open Duplexed (Face-to-Face)	SA055FR0