

**SILVERTHIN JSA060CP0****6 in Sealed Type C Thin Section Bearing****Specifications**

Bore (B)	6.000 in
Outside Diameter (D)	6.500 in
Width	1/4"
Land Diameter (L <sub>1</sub> )	6.186 in
Land Diameter (L <sub>2</sub> )	6.314 in
Approximate Weight	0.28 lbs
Separator	Brass; snapover separator
Precision Class	ABEC Class 1
Bearing Type	Radial Contact (Type C)
Seals, Shields	Buna N Rubber Seal
Unit System	Inch

**Load Capacities**

Static Radial Load	1,900 lbf
Dynamic Radial Load	720 lbf
Torque Max No Load	52 in-lbs

**Interchange**

Silverthin	<a href="#">JSA060CP0</a>	Kaydon	<a href="#">JA060CPO</a>	Kaydon	<a href="#">JA060CPO</a>	INA	<a href="#">CSCA0602RS</a>
SKF	<a href="#">FPCA6002RS1</a>	FAG	<a href="#">L10QA6002RSD</a>	NSK	<a href="#">NBC15206DD</a>	NTN	<a href="#">KRA152LL</a>
SSB	<a href="#">RJA060CP0</a>						

**Brass; snapover separator**

1/8" balls

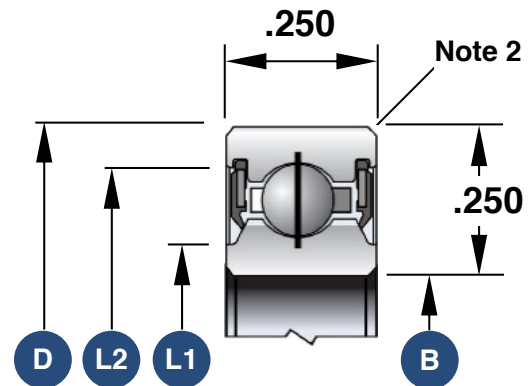

1. Load capacities are not additive
2. The maximum shaft or housing fillet radius that the bearing corners will clear for this series is 0.025"
3. Race Width Tolerance: +0.000 -0.005"

**Also Available**

Open Angular Contact	<a href="#">SA060ARO</a>
Open Radial Contact	<a href="#">SA060CPO</a>
Open 4-Point Contact	<a href="#">SA060XPO</a>
Sealed 4-Point Contact	<a href="#">JSA060XPO</a>
Open Duplexed (Back-to-Back)	<a href="#">SA060BR0</a>
Open Duplexed (Face-to-Face)	<a href="#">SA060FR0</a>