

SILVERTHIN JSA065CPO**6.5 in Sealed Type C Thin Section Bearing****Specifications**

Bore (B)	6.500 in
Outside Diameter (D)	7.000 in
Width	1/4"
Land Diameter (L ₁)	6.686 in
Land Diameter (L ₂)	6.814 in
Approximate Weight	0.30 lbs
Separator	Brass; snapover separator
Precision Class	ABEC Class 1
Bearing Type	Radial Contact (Type C)
Seals, Shields	Buna N Rubber Seal
Unit System	Inch

Load Capacities

Static Radial Load	2,050 lbf
Dynamic Radial Load	755 lbf
Torque Max No Load	61 in-lbs

Interchange

Silverthin	JSA065CPO	Kaydon	JA065CPO	Kaydon	JA065CPO	INA	CSCA0652RS
SKF	FPCA6082RS1	FAG	L10QA6082RSD	NSK	NBC16506DD	NTN	KRA165LL
SSB	RJA065CPO						

Brass; snapover separator

1/8" balls

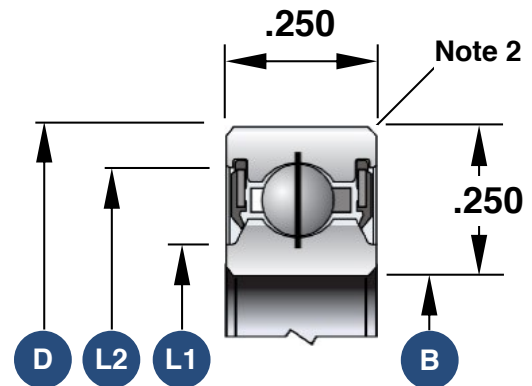

1. Load capacities are not additive
2. The maximum shaft or housing fillet radius that the bearing corners will clear for this series is 0.025"
3. Race Width Tolerance: +0.000 -0.005"

Also Available

Open Angular Contact	SA065AR0
Open Radial Contact	SA065CPO
Open 4-Point Contact	SA065XPO
Sealed 4-Point Contact	JSA065XPO
Open Duplexed (Back-to-Back)	SA065BR0
Open Duplexed (Face-to-Face)	SA065FR0