

SILVERTHIN JSB020CP0**2 in Sealed Type C Thin Section Bearing****Specifications**

Bore (B)	2.000 in
Outside Diameter (D)	2.625 in
Width	5/16"
Land Diameter (L ₁)	2.231 in
Land Diameter (L ₂)	2.393 in
Approximate Weight	0.16 lbs
Separator	Brass; snapover separator
Precision Class	ABEC Class 1
Bearing Type	Radial Contact (Type C)
Seals, Shields	Buna N Rubber Seal
Unit System	Inch

Load Capacities

Static Radial Load	930 lbf
Dynamic Radial Load	575 lbf
Torque Max No Load	6 in-lbs

Interchange

Silverthin	JSB020CP0	Kaydon	JB020CP0	Kaydon	JB020CP0	INA	CSCB020.2RS
SKF	FPCB2002RS1	FAG	L10RA2002RSD	NSK	NBC05007DD	NTN	KRB050LL
SSB	RJB020CP0						

Brass; snapover separator

5/32" balls

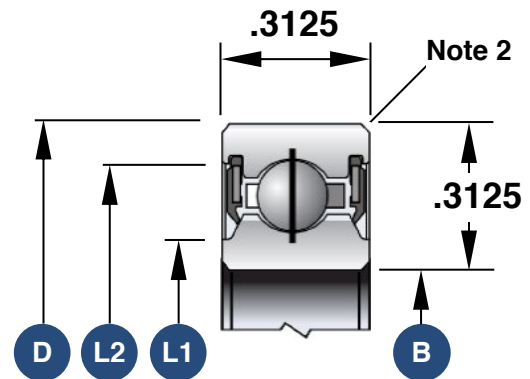

1. Load capacities are not additive
2. The maximum shaft or housing fillet radius that the bearing corners will clear for this series is 0.040"
3. Race Width Tolerance: +0.000 -0.005"

Also Available

Open Angular Contact	SB020AR0
Open Radial Contact	SB020CP0
Open 4-Point Contact	SB020XP0
Sealed 4-Point Contact	JSB020XP0
Open Duplexed (Back-to-Back)	SB020BR0
Open Duplexed (Face-to-Face)	SB020FR0