

SILVERTHIN JSB025CP0**2.5 in Sealed Type C Thin Section Bearing****Specifications**

Bore (B)	2.500 in
Outside Diameter (D)	3.125 in
Width	5/16"
Land Diameter (L ₁)	2.731 in
Land Diameter (L ₂)	2.893 in
Approximate Weight	0.19 lbs
Separator	Brass; snapover separator
Precision Class	ABEC Class 1
Bearing Type	Radial Contact (Type C)
Seals, Shields	Buna N Rubber Seal
Unit System	Inch

Load Capacities

Static Radial Load	1,140 lbf
Dynamic Radial Load	645 lbf
Torque Max No Load	8 in-lbs

Interchange

Silverthin	JSB025CP0	Kaydon	JB025CP0	Kaydon	JB025CP0	INA	CSCB0252RS
SKF	FPCB2082RS1	FAG	L10RA2082RSD	NSK	NBC06307DD	NTN	KRB063LL
SSB	RJB025CP0						

Brass; snapover separator

5/32" balls

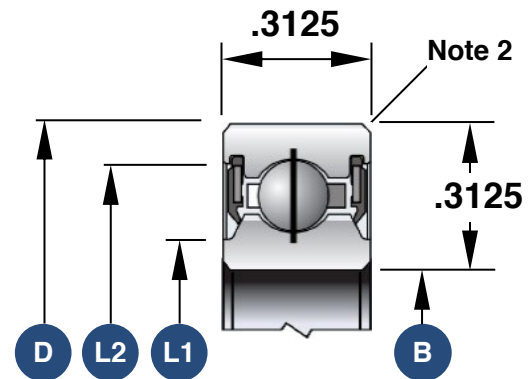

1. Load capacities are not additive
2. The maximum shaft or housing fillet radius that the bearing corners will clear for this series is 0.040"
3. Race Width Tolerance: +0.000 -0.005"

Also Available

Open Angular Contact	SB025AR0
Open Radial Contact	SB025CP0
Open 4-Point Contact	SB025XP0
Sealed 4-Point Contact	JSB025XP0
Open Duplexed (Back-to-Back)	SB025BR0
Open Duplexed (Face-to-Face)	SB025FR0