

SILVERTHIN JSB035CP0**3.5 in Sealed Type C Thin Section Bearing****Specifications**

Bore (B)	3.500 in
Outside Diameter (D)	4.125 in
Width	5/16"
Land Diameter (L ₁)	3.731 in
Land Diameter (L ₂)	3.893 in
Approximate Weight	0.29 lbs
Separator	Brass; snapover separator
Precision Class	ABEC Class 1
Bearing Type	Radial Contact (Type C)
Seals, Shields	Buna N Rubber Seal
Unit System	Inch

Load Capacities

Static Radial Load	1,540 lbf
Dynamic Radial Load	765 lbf
Torque Max No Load	16 in-lbs

Interchange

Silverthin	JSB035CP0	Kaydon	JB035CP0	Kaydon	JB035CP0	INA	CSCB0352RS
SKF	FPCB3082RS1	FAG	L10RA3082RSD	NSK	NBC08807DD	NTN	KRB088LL
SSB	RJB035CP0						

Brass; snapover separator

5/32" balls

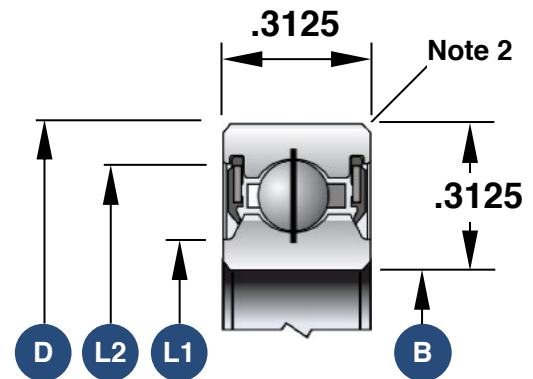

1. Load capacities are not additive
2. The maximum shaft or housing fillet radius that the bearing corners will clear for this series is 0.040"
3. Race Width Tolerance: +0.000 -0.005"

Also Available

Open Angular Contact	SB035AR0
Open Radial Contact	SB035CP0
Open 4-Point Contact	SB035XP0
Sealed 4-Point Contact	JSB035XP0
Open Duplexed (Back-to-Back)	SB035BR0
Open Duplexed (Face-to-Face)	SB035FR0