

SILVERTHIN JSB040CP0**4 in Sealed Type C Thin Section Bearing****Specifications**

Bore (B)	4.000 in
Outside Diameter (D)	4.625 in
Width	5/16"
Land Diameter (L ₁)	4.231 in
Land Diameter (L ₂)	4.393 in
Approximate Weight	0.30 lbs
Separator	Brass; snapover separator
Precision Class	ABEC Class 1
Bearing Type	Radial Contact (Type C)
Seals, Shields	Buna N Rubber Seal
Unit System	Inch

Load Capacities

Static Radial Load	1,750 lbf
Dynamic Radial Load	825 lbf
Torque Max No Load	20 in-lbs

Interchange

Silverthin	JSB040CP0	Kaydon	JB040CP0	Kaydon	JB040CP0	INA	CSCB0402RS
SKF	FPCB4002RS1	FAG	L10RA4002RSD	NSK	NBC10107DD	NTN	KRB101LL
SSB	RJB040CP0						

Brass; snapover separator

5/32" balls

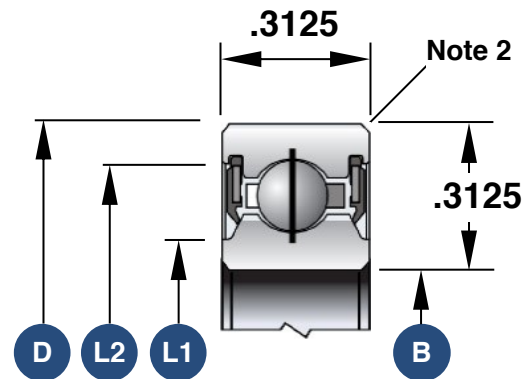

1. Load capacities are not additive
2. The maximum shaft or housing fillet radius that the bearing corners will clear for this series is 0.040"
3. Race Width Tolerance: +0.000 -0.005"

Also Available

Open Angular Contact	SB040AR0
Open Radial Contact	SB040CP0
Open 4-Point Contact	SB040XP0
Sealed 4-Point Contact	JSB040XP0
Open Duplexed (Back-to-Back)	SB040BR0
Open Duplexed (Face-to-Face)	SB040FR0