

SILVERTHIN JSB042CP0**4.25 in Sealed Type C Thin Section Bearing****Specifications**

Bore (B)	4.250 in
Outside Diameter (D)	4.875 in
Width	5/16"
Land Diameter (L ₁)	4.481 in
Land Diameter (L ₂)	4.643 in
Approximate Weight	0.31 lbs
Separator	Brass; snapover separator
Precision Class	ABEC Class 1
Bearing Type	Radial Contact (Type C)
Seals, Shields	Buna N Rubber Seal
Unit System	Inch

Load Capacities

Static Radial Load	1,830 lbf
Dynamic Radial Load	845 lbf
Torque Max No Load	24 in-lbs

Interchange

Silverthin	JSB042CP0	Kaydon	JB042CP0	Kaydon	JB042CP0	INA	CSCB0422RS
SKF	FPCB4042RS1	FAG	L10RA4042RSD	NSK	NBC10707DD	NTN	KRB107LL
SSB	RJB042CP0						

Brass; snapover separator

5/32" balls

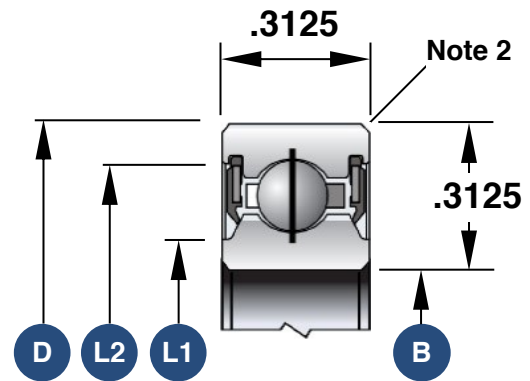

1. Load capacities are not additive
2. The maximum shaft or housing fillet radius that the bearing corners will clear for this series is 0.040"
3. Race Width Tolerance: +0.000 -0.005"

Also Available

Open Angular Contact	SB042AR0
Open Radial Contact	SB042CP0
Open 4-Point Contact	SB042XP0
Sealed 4-Point Contact	JSB042XP0
Open Duplexed (Back-to-Back)	SB042BR0
Open Duplexed (Face-to-Face)	SB042FR0