

**SILVERTHIN JSB042XP0****4.25 in Sealed Type X Thin Section Bearing****Specifications**

Bore (B)	4.250 in
Outside Diameter (D)	4.875 in
Width	5/16"
Land Diameter (L <sub>1</sub> )	4.481 in
Land Diameter (L <sub>2</sub> )	4.643 in
Approximate Weight	0.31 lbs
Separator	Brass; snapover separator
Precision Class	ABEC Class 1
Bearing Type	4-Point Contact (Type X)
Seals, Shields	Buna N Rubber Seal
Unit System	Inch

**Load Capacities**

Static Radial Load	1,830 lbf
Dynamic Radial Load	1,120 lbf
Static Thrust Load	4,570 lbf
Dynamic Thrust Load	1,780 lbf
Static Moment Load	4,170 in-lbs
Dynamic Moment Load	1,915 in-lbs
Torque Max No Load	24 in-lbs

**Interchange**

Silverthin	<b>JSB042XP0</b>	Kaydon	<b>JB042XP0</b>	Kaydon	<b>JB042XP0</b>	INA	<b>CSXB0422RS</b>
SKF	<b>FPXB4042RS1</b>	FAG	<b>L18RA4042RSD</b>	NSK	<b>NBX10707DD</b>	NTN	<b>KXB107LL</b>
SSB	<b>RJB042XP0</b>						

**Brass; snapover separator**

5/32" balls

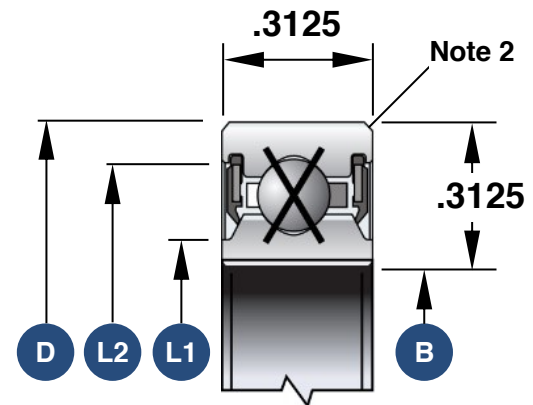

1. Load capacities are not additive
2. The maximum shaft or housing fillet radius that the bearing corners will clear for this series is 0.040"
3. Race Width Tolerance: +0.000 -0.005"

**Also Available**

Open Angular Contact	<b>SB042AR0</b>
Open Radial Contact	<b>SB042CP0</b>
Open 4-Point Contact	<b>SB042XP0</b>
Sealed Radial Contact	<b>JSB042CP0</b>
Open Duplexed (Back-to-Back)	<b>SB042BR0</b>
Open Duplexed (Face-to-Face)	<b>SB042FR0</b>