

**SILVERTHIN JSB045XP0****4.5 in Sealed Type X Thin Section Bearing****Specifications**

Bore (B)	4.500 in
Outside Diameter (D)	5.125 in
Width	5/16"
Land Diameter (L <sub>1</sub> )	4.731 in
Land Diameter (L <sub>2</sub> )	4.893 in
Approximate Weight	0.33 lbs
Separator	Brass; snapover separator
Precision Class	ABEC Class 1
Bearing Type	4-Point Contact (Type X)
Seals, Shields	Buna N Rubber Seal
Unit System	Inch

**Load Capacities**

Static Radial Load	1,950 lbf
Dynamic Radial Load	1,165 lbf
Static Thrust Load	4,880 lbf
Dynamic Thrust Load	1,850 lbf
Static Moment Load	4,690 in-lbs
Dynamic Moment Load	2,105 in-lbs
Torque Max No Load	28 in-lbs

**Interchange**

Silverthin	<a href="#">JSB045XP0</a>	Kaydon	<a href="#">JB045XP0</a>	Kaydon	<a href="#">JB045XP0</a>	INA	<a href="#">CSXB0452RS</a>
SKF	<a href="#">FPXB4082RS1</a>	FAG	<a href="#">L18RA4082RSD</a>	NSK	<a href="#">NBX11407DD</a>	NTN	<a href="#">KXB114LL</a>
SSB	<a href="#">RJB045XP0</a>						

**Brass; snapover separator**

5/32" balls

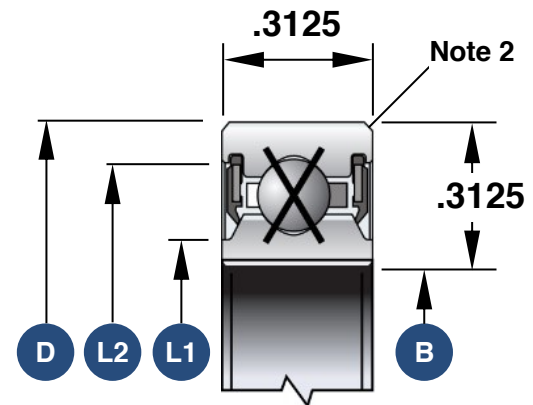

1. Load capacities are not additive
2. The maximum shaft or housing fillet radius that the bearing corners will clear for this series is 0.040"
3. Race Width Tolerance: +0.000 -0.005"

**Also Available**

Open Angular Contact	<a href="#">SB045AR0</a>
Open Radial Contact	<a href="#">SB045CP0</a>
Open 4-Point Contact	<a href="#">SB045XP0</a>
Sealed Radial Contact	<a href="#">JSB045CP0</a>
Open Duplexed (Back-to-Back)	<a href="#">SB045BR0</a>
Open Duplexed (Face-to-Face)	<a href="#">SB045FR0</a>