

**SILVERTHIN JSB065CPO****6.5 in Sealed Type C Thin Section Bearing****Specifications**

Bore (B)	6.500 in
Outside Diameter (D)	7.125 in
Width	5/16"
Land Diameter (L <sub>1</sub> )	6.731 in
Land Diameter (L <sub>2</sub> )	6.893 in
Approximate Weight	0.47 lbs
Separator	Brass; snapover separator
Precision Class	ABEC Class 1
Bearing Type	Radial Contact (Type C)
Seals, Shields	Buna N Rubber Seal
Unit System	Inch

**Load Capacities**

Static Radial Load	2,760 lbf
Dynamic Radial Load	1,080 lbf
Torque Max No Load	61 in-lbs

**Interchange**

Silverthin	<a href="#">JSB065CPO</a>	Kaydon	<a href="#">JB065CPO</a>	Kaydon	<a href="#">JB065CPO</a>	INA	<a href="#">CSCB0652RS</a>
SKF	<a href="#">FPCB6082RS1</a>	FAG	<a href="#">L10RA6082RSD</a>	NSK	<a href="#">NBC16507DD</a>	NTN	<a href="#">KRB165LL</a>
SSB	<a href="#">RJB065CPO</a>						

**Brass; snapover separator**

5/32" balls

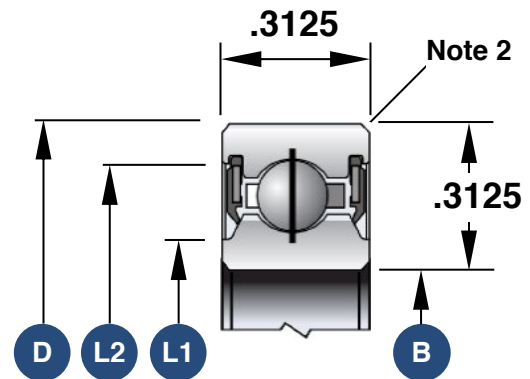

1. Load capacities are not additive
2. The maximum shaft or housing fillet radius that the bearing corners will clear for this series is 0.040"
3. Race Width Tolerance: +0.000 -0.005"

**Also Available**

Open Angular Contact	<a href="#">SB065AR0</a>
Open Radial Contact	<a href="#">SB065CPO</a>
Open 4-Point Contact	<a href="#">SB065XP0</a>
Sealed 4-Point Contact	<a href="#">JSB065XP0</a>
Open Duplexed (Back-to-Back)	<a href="#">SB065BR0</a>
Open Duplexed (Face-to-Face)	<a href="#">SB065FR0</a>