

**SILVERTHIN JSU110XP0****11 in Sealed Type X Thin Section Bearing****Specifications**

Bore (B)	11.000 in
Outside Diameter (D)	11.750 in
Width	1/2"
Land Diameter (L <sub>1</sub> )	11.277 in
Land Diameter (L <sub>2</sub> )	11.473 in
Approximate Weight	1.43 lbs
Separator	Brass; snapover separator
Precision Class	ABEC Class 1
Bearing Type	4-Point Contact (Type X)
Seals, Shields	Buna N Rubber Seal
Unit System	Inch

**Load Capacities**

Static Radial Load	5,470 lbf
Dynamic Radial Load	2,495 lbf
Static Thrust Load	13,680 lbf
Dynamic Thrust Load	4,180 lbf
Static Moment Load	31,110 in-lbs
Dynamic Moment Load	10,650 in-lbs
Torque Max No Load	19 in-lbs

**Interchange**

Silverthin	<a href="#">JSU110XP0</a>	Kaydon	<a href="#">JU110XP0</a>	Kaydon	<a href="#">JU110XP0</a>	INA	<a href="#">CSXU1102RS</a>
SKF	<a href="#">FPXU11002RS1</a>	FAG	<a href="#">L18SG11002RSD</a>	NSK	<a href="#">NBX27912DD</a>	NTN	<a href="#">KXJ110LL</a>
SSB	<a href="#">RJU110XP0</a>	RBC	<a href="#">JU110XP0*RBC</a>				

**Brass; snapover separator**

3/16" balls

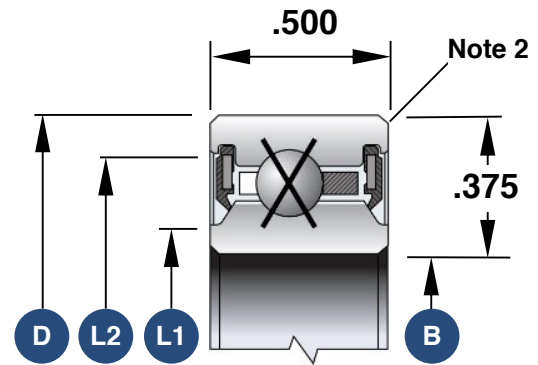

1. Load capacities are not additive
2. The maximum shaft or housing fillet radius that the bearing corners will clear for this series is 0.040"
3. Race Width Tolerance: +0.000 -0.005"

**Also Available**

Open Angular Contact	<a href="#">SC110AR0</a>
Open Radial Contact	<a href="#">SC110CP0</a>
Open 4-Point Contact	<a href="#">SC110XP0</a>
Sealed Radial Contact	<a href="#">JSU110CP0</a>
Open Duplexed (Back-to-Back)	<a href="#">SC110BR0</a>
Open Duplexed (Face-to-Face)	<a href="#">SC110FR0</a>