

SILVERTHIN SA020AR0**2 in Open Type A Thin Section Bearing****Specifications**

Bore (B)	2.000 in
Outside Diameter (D)	2.500 in
Width	1/4"
Land Diameter (L ₁)	2.186 in
Land Diameter (L ₂)	2.314 in
Land Diameter (L ₃)	2.369 in
Approximate Weight	0.10 lbs
Separator	Brass; one piece pocket separator
Precision Class	ABEC Class 1
Bearing Type	Angular Contact (Type A)
Seals, Shields	None (Open)
Unit System	Inch

Load Capacities

Static Radial Load	790 lbf
Dynamic Radial Load	405 lbf
Static Thrust Load	2,280 lbf
Dynamic Thrust Load	960 lbf

Interchange

Silverthin	SA020AR0	Kaydon	KA020AR0	Kaydon	KA020AR0	INA	CSEA020
SKF	FPAA200	FAG	L15QA200	NSK	NBA5006	NTN	KYA020
SSB	RA020AR0	RBC	KA020AR0*RBC				

Brass; one piece pocket separator

1/8" balls

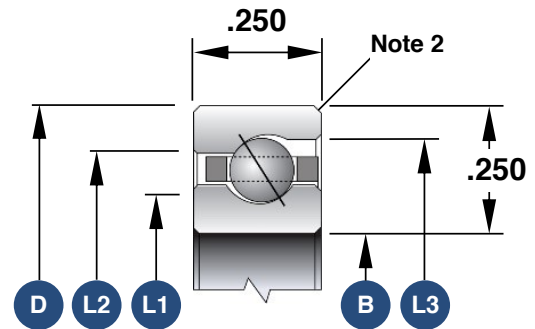

1. Load capacities are not additive
2. The maximum shaft or housing fillet radius that the bearing corners will clear for this series is 0.025"
3. Race Width Tolerance: +0.000 -0.005"

Also Available

Open Radial Contact	SA020CP0
Open 4-Point Contact	SA020XP0
Sealed Radial Contact	JSA020CP0
Sealed 4-Point Contact	JSA020XP0
Open Duplexed (Back-to-Back)	SA020BR0
Open Duplexed (Face-to-Face)	SA020FR0