

SILVERTHIN SA020CP0**2 in Open Type C Thin Section Bearing****Specifications**

Bore (B)	2.000 in
Outside Diameter (D)	2.500 in
Width	1/4"
Land Diameter (L ₁)	2.186 in
Land Diameter (L ₂)	2.314 in
Approximate Weight	0.10 lbs
Separator	Brass; snapover separator
Precision Class	ABEC Class 1
Bearing Type	Radial Contact (Type C)
Seals, Shields	None (Open)
Unit System	Inch

Load Capacities

Static Radial Load	680 lbf
Dynamic Radial Load	395 lbf

Interchange

Silverthin	SA020CP0	Kaydon	KA020CP0	Kaydon	KA020CP0	INA	CSCA020
SKF	FPCA200	FAG	L10QA200	NSK	NBC5006	NTN	KRA020
SSB	RA020CP0	RBC	KA020CP0*RBC				

Brass; snapover separator

1/8" balls

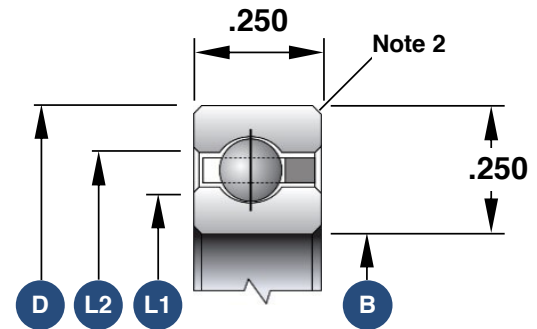

1. Load capacities are not additive
2. The maximum shaft or housing fillet radius that the bearing corners will clear for this series is 0.025"
3. Race Width Tolerance: +0.000 -0.005"

Also Available

Open Angular Contact	SA020ARO
Open 4-Point Contact	SA020XPO
Sealed Radial Contact	JSA020CP0
Sealed 4-Point Contact	JSA020XPO
Open Duplexed (Back-to-Back)	SA020BR0
Open Duplexed (Face-to-Face)	SA020FR0