

**SILVERTHIN SA020XP0****2 in Open Type X Thin Section Bearing****Specifications**

Bore (B)	2.000 in
Outside Diameter (D)	2.500 in
Width	1/4"
Land Diameter (L <sub>1</sub> )	2.186 in
Land Diameter (L <sub>2</sub> )	2.314 in
Approximate Weight	0.10 lbs
Separator	Brass; snapover separator
Precision Class	ABEC Class 1
Bearing Type	4-Point Contact (Type X)
Seals, Shields	None (Open)
Unit System	Inch

**Load Capacities**

Static Radial Load	680 lbf
Dynamic Radial Load	515 lbf
Static Thrust Load	1,710 lbf
Dynamic Thrust Load	790 lbf
Static Moment Load	770 in-lbs
Dynamic Moment Load	435 in-lbs

**Interchange**

Silverthin	<a href="#">SA020XP0</a>	Kaydon	<a href="#">KA020XP0</a>	Kaydon	<a href="#">KA020XP0</a>	INA	<a href="#">CSXA020</a>
SKF	<a href="#">FPXA200</a>	FAG	<a href="#">L18QA200</a>	NSK	<a href="#">NBX5006</a>	NTN	<a href="#">KXA020</a>
SSB	<a href="#">RA020XP0</a>	RBC	<a href="#">KA020XP0*RBC</a>				

**Brass; snapover separator**

1/8" balls

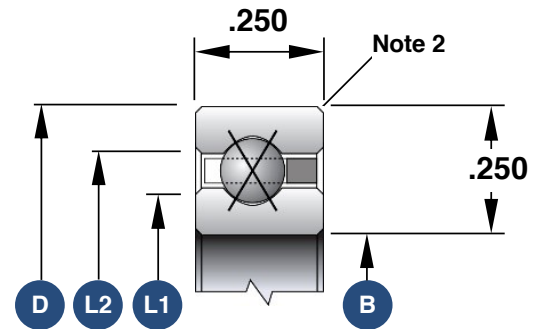

1. Load capacities are not additive
2. The maximum shaft or housing fillet radius that the bearing corners will clear for this series is 0.025"
3. Race Width Tolerance: +0.000 -0.005"

**Also Available**

Open Angular Contact	<a href="#">SA020ARO</a>
Open Radial Contact	<a href="#">SA020CPO</a>
Sealed Radial Contact	<a href="#">JSA020CPO</a>
Sealed 4-Point Contact	<a href="#">JSA020XP0</a>
Open Duplexed (Back-to-Back)	<a href="#">SA020BR0</a>
Open Duplexed (Face-to-Face)	<a href="#">SA020FR0</a>