

SILVERTHIN SA025AR0**2.5 in Open Type A Thin Section Bearing****Specifications**

| | |
|---------------------------------|-----------------------------------|
| Bore (B) | 2.500 in |
| Outside Diameter (D) | 3.000 in |
| Width | 1/4" |
| Land Diameter (L ₁) | 2.686 in |
| Land Diameter (L ₂) | 2.814 in |
| Land Diameter (L ₃) | 2.869 in |
| Approximate Weight | 0.13 lbs |
| Separator | Brass; one piece pocket separator |
| Precision Class | ABEC Class 1 |
| Bearing Type | Angular Contact (Type A) |
| Seals, Shields | None (Open) |
| Unit System | Inch |

Load Capacities

| | |
|---------------------|-----------|
| Static Radial Load | 960 lbf |
| Dynamic Radial Load | 460 lbf |
| Static Thrust Load | 2,780 lbf |
| Dynamic Thrust Load | 1,100 lbf |

Interchange

| | | | | | | | |
|------------|--------------------------|--------|------------------------------|--------|--------------------------|-----|-------------------------|
| Silverthin | SA025AR0 | Kaydon | KA025AR0 | Kaydon | KA025AR0 | INA | CSEA025 |
| SKF | FPAA208 | FAG | L15QA208 | NSK | NBA6306 | NTN | KYA025 |
| SSB | RA025AR0 | RBC | KA025AR0*RBC | | | | |

Brass; one piece pocket separator

1/8" balls

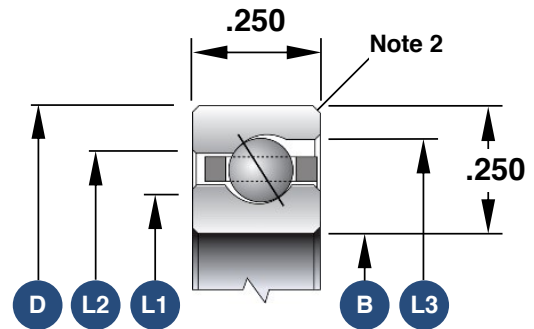

1. Load capacities are not additive
2. The maximum shaft or housing fillet radius that the bearing corners will clear for this series is 0.025"
3. Race Width Tolerance: +0.000 -0.005"

Also Available

| | |
|------------------------------|---------------------------|
| Open Radial Contact | SA025CP0 |
| Open 4-Point Contact | SA025XP0 |
| Sealed Radial Contact | JSA025CP0 |
| Sealed 4-Point Contact | JSA025XP0 |
| Open Duplexed (Back-to-Back) | SA025BR0 |
| Open Duplexed (Face-to-Face) | SA025FR0 |