

SILVERTHIN SA025CP0**2.5 in Open Type C Thin Section Bearing****Specifications**

Bore (B)	2.500 in
Outside Diameter (D)	3.000 in
Width	1/4"
Land Diameter (L ₁)	2.686 in
Land Diameter (L ₂)	2.814 in
Approximate Weight	0.13 lbs
Separator	Brass; snapover separator
Precision Class	ABEC Class 1
Bearing Type	Radial Contact (Type C)
Seals, Shields	None (Open)
Unit System	Inch

Load Capacities

Static Radial Load	830 lbf
Dynamic Radial Load	440 lbf

Interchange

Silverthin	SA025CP0	Kaydon	KA025CP0	Kaydon	KA025CP0	INA	CSCA025
SKF	FPCA208	FAG	L10QA208	NSK	NBC6306	NTN	KRA025
SSB	RA025CP0	RBC	KA025CP0*RBC				

Brass; snapover separator

1/8" balls

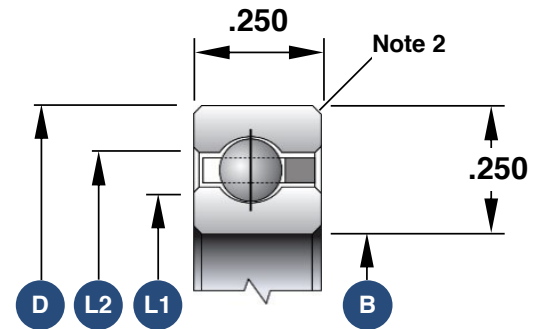

1. Load capacities are not additive
2. The maximum shaft or housing fillet radius that the bearing corners will clear for this series is 0.025"
3. Race Width Tolerance: +0.000 -0.005"

Also Available

Open Angular Contact	SA025AR0
Open 4-Point Contact	SA025XP0
Sealed Radial Contact	JSA025CP0
Sealed 4-Point Contact	JSA025XP0
Open Duplexed (Back-to-Back)	SA025BR0
Open Duplexed (Face-to-Face)	SA025FR0