

SILVERTHIN SA025XP0**2.5 in Open Type X Thin Section Bearing****Specifications**

Bore (B)	2.500 in
Outside Diameter (D)	3.000 in
Width	1/4"
Land Diameter (L ₁)	2.686 in
Land Diameter (L ₂)	2.814 in
Approximate Weight	0.13 lbs
Separator	Brass; snapover separator
Precision Class	ABEC Class 1
Bearing Type	4-Point Contact (Type X)
Seals, Shields	None (Open)
Unit System	Inch

Load Capacities

Static Radial Load	830 lbf
Dynamic Radial Load	585 lbf
Static Thrust Load	2,090 lbf
Dynamic Thrust Load	910 lbf
Static Moment Load	1,150 in-lbs
Dynamic Moment Load	600 in-lbs

Interchange

Silverthin	SA025XP0	Kaydon	KA025XP0	Kaydon	KA025XP0	INA	CSXA025
SKF	FPXA208	FAG	L18QA208	NSK	NBX6306	NTN	KXA025
SSB	RA025XP0	RBC	KA025XP0*RBC				

Brass; snapover separator

1/8" balls

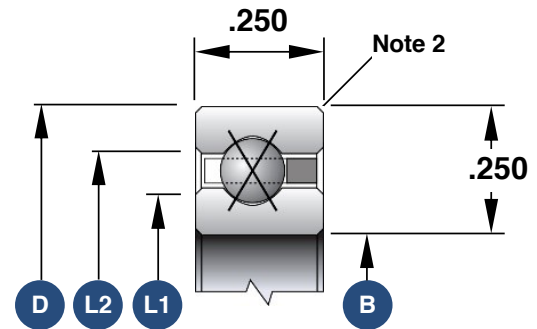

1. Load capacities are not additive
2. The maximum shaft or housing fillet radius that the bearing corners will clear for this series is 0.025"
3. Race Width Tolerance: +0.000 -0.005"

Also Available

Open Angular Contact	SA025AR0
Open Radial Contact	SA025CP0
Sealed Radial Contact	JSA025CP0
Sealed 4-Point Contact	JSA025XP0
Open Duplexed (Back-to-Back)	SA025BR0
Open Duplexed (Face-to-Face)	SA025FR0