

SILVERTHIN SA030AR0**3 in Open Type A Thin Section Bearing****Specifications**

Bore (B)	3.000 in
Outside Diameter (D)	3.500 in
Width	1/4"
Land Diameter (L ₁)	3.186 in
Land Diameter (L ₂)	3.314 in
Land Diameter (L ₃)	3.367 in
Approximate Weight	0.15 lbs
Separator	Brass; one piece pocket separator
Precision Class	ABEC Class 1
Bearing Type	Angular Contact (Type A)
Seals, Shields	None (Open)
Unit System	Inch

Load Capacities

Static Radial Load	1,140 lbf
Dynamic Radial Load	505 lbf
Static Thrust Load	3,290 lbf
Dynamic Thrust Load	1,230 lbf

Interchange

Silverthin	SA030AR0	Kaydon	KA030AR0	Kaydon	KA030AR0	INA	CSEA030
SKF	FPAA300	FAG	L15QA300	NSK	NBA7606	NTN	KYA030
SSB	RA030AR0	RBC	KA030AR0*RBC				

Brass; one piece pocket separator

1/8" balls

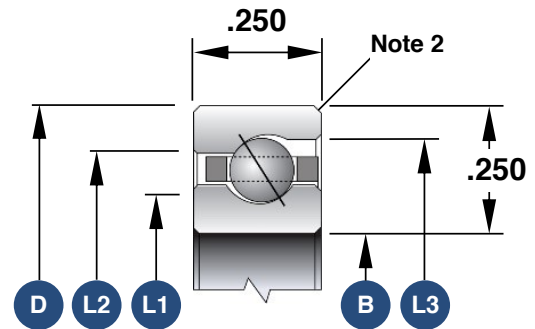

1. Load capacities are not additive
2. The maximum shaft or housing fillet radius that the bearing corners will clear for this series is 0.025"
3. Race Width Tolerance: +0.000 -0.005"

Also Available

Open Radial Contact	SA030CP0
Open 4-Point Contact	SA030XP0
Sealed Radial Contact	JSA030CP0
Sealed 4-Point Contact	JSA030XP0
Open Duplexed (Back-to-Back)	SA030BR0
Open Duplexed (Face-to-Face)	SA030FR0