

SILVERTHIN SA030CP0**3 in Open Type C Thin Section Bearing****Specifications**

Bore (B)	3.000 in
Outside Diameter (D)	3.500 in
Width	1/4"
Land Diameter (L ₁)	3.186 in
Land Diameter (L ₂)	3.314 in
Approximate Weight	0.15 lbs
Separator	Brass; snapover separator
Precision Class	ABEC Class 1
Bearing Type	Radial Contact (Type C)
Seals, Shields	None (Open)
Unit System	Inch

Load Capacities

Static Radial Load	990 lbf
Dynamic Radial Load	485 lbf

Interchange

Silverthin	SA030CP0	Kaydon	KA030CP0	Kaydon	KA030CP0	INA	CSCA030
SKF	FPCA300	FAG	L10QA300	NSK	NBC7606	NTN	KRA030
SSB	RA030CP0	RBC	KA030CP0*RBC				

Brass; snapover separator

1/8" balls

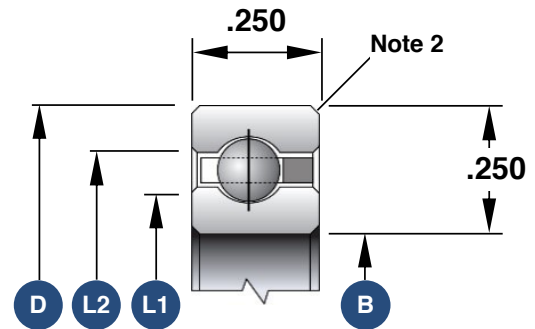

1. Load capacities are not additive
2. The maximum shaft or housing fillet radius that the bearing corners will clear for this series is 0.025"
3. Race Width Tolerance: +0.000 -0.005"

Also Available

Open Angular Contact	SA030ARO
Open 4-Point Contact	SA030XPO
Sealed Radial Contact	JSA030CP0
Sealed 4-Point Contact	JSA030XPO
Open Duplexed (Back-to-Back)	SA030BR0
Open Duplexed (Face-to-Face)	SA030FR0