

SILVERTHIN SA030XP0**3 in Open Type X Thin Section Bearing****Specifications**

Bore (B)	3.000 in
Outside Diameter (D)	3.500 in
Width	1/4"
Land Diameter (L ₁)	3.186 in
Land Diameter (L ₂)	3.314 in
Approximate Weight	0.15 lbs
Separator	Brass; snapover separator
Precision Class	ABEC Class 1
Bearing Type	4-Point Contact (Type X)
Seals, Shields	None (Open)
Unit System	Inch

Load Capacities

Static Radial Load	990 lbf
Dynamic Radial Load	645 lbf
Static Thrust Load	2,470 lbf
Dynamic Thrust Load	1,010 lbf
Static Moment Load	1,600 in-lbs
Dynamic Moment Load	785 in-lbs

Interchange

Silverthin	SA030XP0	Kaydon	KA030XP0	Kaydon	KA030XP0	INA	CSXA030
SKF	FPXA300	FAG	L18QA300	NSK	NBX7606	NTN	KXA030
SSB	RA030XP0	RBC	KA030XP0*RBC				

Brass; snapover separator

1/8" balls

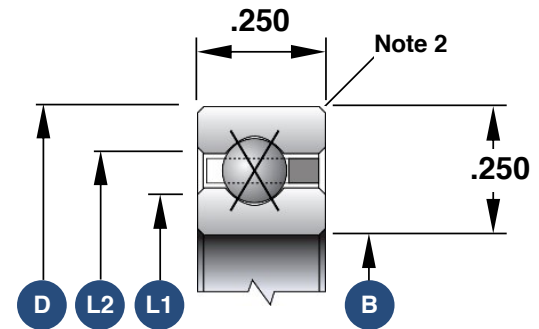

1. Load capacities are not additive
2. The maximum shaft or housing fillet radius that the bearing corners will clear for this series is 0.025"
3. Race Width Tolerance: +0.000 -0.005"

Also Available

Open Angular Contact	SA030ARO
Open Radial Contact	SA030CPO
Sealed Radial Contact	JSA030CPO
Sealed 4-Point Contact	JSA030XP0
Open Duplexed (Back-to-Back)	SA030BR0
Open Duplexed (Face-to-Face)	SA030FR0