

SILVERTHIN SA035AR0**3.5 in Open Type A Thin Section Bearing****Specifications**

Bore (B)	3.500 in
Outside Diameter (D)	4.000 in
Width	1/4"
Land Diameter (L ₁)	3.686 in
Land Diameter (L ₂)	3.814 in
Land Diameter (L ₃)	3.867 in
Approximate Weight	0.18 lbs
Separator	Brass; one piece pocket separator
Precision Class	ABEC Class 1
Bearing Type	Angular Contact (Type A)
Seals, Shields	None (Open)
Unit System	Inch

Load Capacities

Static Radial Load	1,310 lbf
Dynamic Radial Load	550 lbf
Static Thrust Load	3,790 lbf
Dynamic Thrust Load	1,350 lbf

Interchange

Silverthin	SA035AR0	Kaydon	KA035AR0	Kaydon	KA035AR0	INA	CSEA035
SKF	FPAA308	FAG	L15QA308	NSK	NBA8806	NTN	KYA035
SSB	RA035AR0	RBC	KA035AR0*RBC				

Brass; one piece pocket separator

1/8" balls

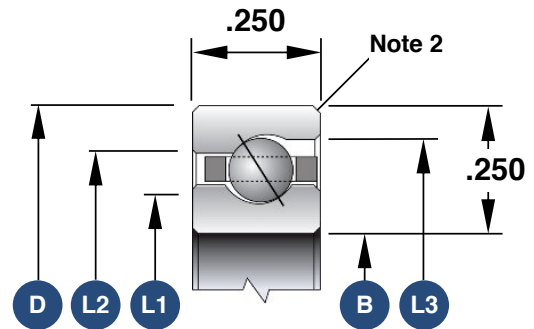

1. Load capacities are not additive
2. The maximum shaft or housing fillet radius that the bearing corners will clear for this series is 0.025"
3. Race Width Tolerance: +0.000 -0.005"

Also Available

Open Radial Contact	SA035CP0
Open 4-Point Contact	SA035XP0
Sealed Radial Contact	JSA035CP0
Sealed 4-Point Contact	JSA035XP0
Open Duplexed (Back-to-Back)	SA035BR0
Open Duplexed (Face-to-Face)	SA035FR0