

SILVERTHIN SA035CP0**3.5 in Open Type C Thin Section Bearing****Specifications**

Bore (B)	3.500 in
Outside Diameter (D)	4.000 in
Width	1/4"
Land Diameter (L ₁)	3.686 in
Land Diameter (L ₂)	3.814 in
Approximate Weight	0.18 lbs
Separator	Brass; snapover separator
Precision Class	ABEC Class 1
Bearing Type	Radial Contact (Type C)
Seals, Shields	None (Open)
Unit System	Inch

Load Capacities

Static Radial Load	1,140 lbf
Dynamic Radial Load	530 lbf

Interchange

Silverthin	SA035CP0	Kaydon	KA035CP0	Kaydon	KA035CP0	INA	CSCA035
SKF	FPCA308	FAG	L10QA308	NSK	NBC8806	NTN	KRA035
SSB	RA035CP0	RBC	KA035CP0*RBC				

Brass; snapover separator

1/8" balls

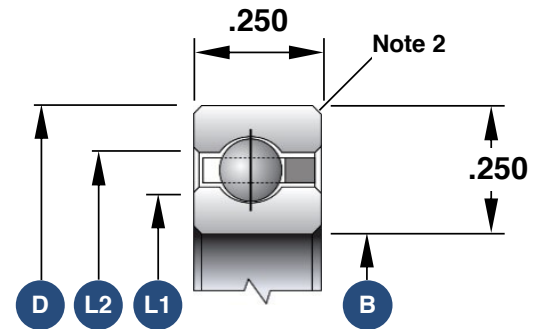

1. Load capacities are not additive
2. The maximum shaft or housing fillet radius that the bearing corners will clear for this series is 0.025"
3. Race Width Tolerance: +0.000 -0.005"

Also Available

Open Angular Contact	SA035AR0
Open 4-Point Contact	SA035XP0
Sealed Radial Contact	JSA035CP0
Sealed 4-Point Contact	JSA035XP0
Open Duplexed (Back-to-Back)	SA035BR0
Open Duplexed (Face-to-Face)	SA035FR0