

SILVERTHIN SA035XP0**3.5 in Open Type X Thin Section Bearing****Specifications**

Bore (B)	3.500 in
Outside Diameter (D)	4.000 in
Width	1/4"
Land Diameter (L ₁)	3.686 in
Land Diameter (L ₂)	3.814 in
Approximate Weight	0.18 lbs
Separator	Brass; snapover separator
Precision Class	ABEC Class 1
Bearing Type	4-Point Contact (Type X)
Seals, Shields	None (Open)
Unit System	Inch

Load Capacities

Static Radial Load	1,140 lbf
Dynamic Radial Load	700 lbf
Static Thrust Load	2,850 lbf
Dynamic Thrust Load	1,110 lbf
Static Moment Load	2,130 in-lbs
Dynamic Moment Load	985 in-lbs

Interchange

Silverthin	SA035XP0	Kaydon	KA035XP0	Kaydon	KA035XP0	INA	CSXA035
SKF	FPXA308	FAG	L18QA308	NSK	NBX8806	NTN	KXA035
SSB	RA035XP0	RBC	KA035XP0*RBC				

Brass; snapover separator

1/8" balls

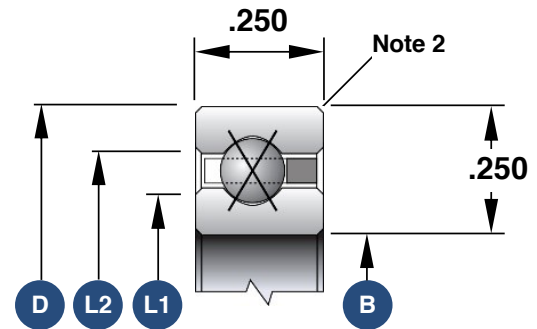

1. Load capacities are not additive
2. The maximum shaft or housing fillet radius that the bearing corners will clear for this series is 0.025"
3. Race Width Tolerance: +0.000 -0.005"

Also Available

Open Angular Contact	SA035AR0
Open Radial Contact	SA035CP0
Sealed Radial Contact	JSA035CP0
Sealed 4-Point Contact	JSA035XP0
Open Duplexed (Back-to-Back)	SA035BR0
Open Duplexed (Face-to-Face)	SA035FR0