

SILVERTHIN SA040AR0**4 in Open Type A Thin Section Bearing****Specifications**

Bore (B)	4.000 in
Outside Diameter (D)	4.500 in
Width	1/4"
Land Diameter (L ₁)	4.186 in
Land Diameter (L ₂)	4.314 in
Land Diameter (L ₃)	4.367 in
Approximate Weight	0.19 lbs
Separator	Brass; one piece pocket separator
Precision Class	ABEC Class 1
Bearing Type	Angular Contact (Type A)
Seals, Shields	None (Open)
Unit System	Inch

Load Capacities

Static Radial Load	1,490 lbf
Dynamic Radial Load	595 lbf
Static Thrust Load	4,300 lbf
Dynamic Thrust Load	1,470 lbf

Interchange

Silverthin	SA040AR0	Kaydon	KA040AR0
SKF	FPAA400	FAG	L15QA400
SSB	RA040AR0	RBC	KA040AR0*RBC

Brass; one piece pocket separator

1/8" balls

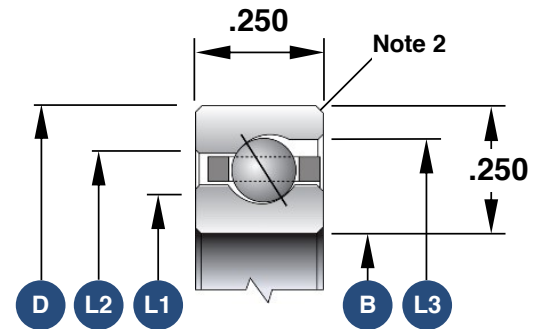

1. Load capacities are not additive
2. The maximum shaft or housing fillet radius that the bearing corners will clear for this series is 0.025"
3. Race Width Tolerance: +0.000 -0.005"

Also Available

Open Radial Contact	SA040CP0
Open 4-Point Contact	SA040XP0
Sealed Radial Contact	JSA040CP0
Sealed 4-Point Contact	JSA040XP0
Open Duplexed (Back-to-Back)	SA040BR0
Open Duplexed (Face-to-Face)	SA040FR0