

SILVERTHIN SA040XPO**4 in Open Type X Thin Section Bearing****Specifications**

Bore (B)	4.000 in
Outside Diameter (D)	4.500 in
Width	1/4"
Land Diameter (L ₁)	4.186 in
Land Diameter (L ₂)	4.314 in
Approximate Weight	0.19 lbs
Separator	Brass; snapover separator
Precision Class	ABEC Class 1
Bearing Type	4-Point Contact (Type X)
Seals, Shields	None (Open)
Unit System	Inch

Load Capacities

Static Radial Load	1,290 lbf
Dynamic Radial Load	755 lbf
Static Thrust Load	3,220 lbf
Dynamic Thrust Load	1,210 lbf
Static Moment Load	2,740 in-lbs
Dynamic Moment Load	1,205 in-lbs

Interchange

Silverthin	SA040XPO	Kaydon	KA040XPO	Kaydon	KA040XPO	INA	CSXA040
SKF	FPXA400	FAG	L18QA400	NSK	NBX10106	NTN	KXA040
SSB	RA040XPO	RBC	KA040XPO*RBC				

Brass; snapover separator

1/8" balls

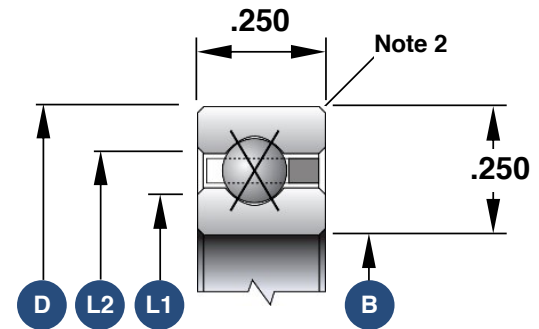

1. Load capacities are not additive
2. The maximum shaft or housing fillet radius that the bearing corners will clear for this series is 0.025"
3. Race Width Tolerance: +0.000 -0.005"

Also Available

Open Angular Contact	SA040ARO
Open Radial Contact	SA040CPO
Sealed Radial Contact	JSA040CPO
Sealed 4-Point Contact	JSA040XPO
Open Duplexed (Back-to-Back)	SA040BR0
Open Duplexed (Face-to-Face)	SA040FR0