

**SILVERTHIN SA042AR0****4.25 in Open Type A Thin Section Bearing****Specifications**

Bore (B)	4.250 in
Outside Diameter (D)	4.750 in
Width	1/4"
Land Diameter (L <sub>1</sub> )	4.436 in
Land Diameter (L <sub>2</sub> )	4.564 in
Land Diameter (L <sub>3</sub> )	4.615 in
Approximate Weight	0.20 lbs
Separator	Brass; one piece pocket separator
Precision Class	ABEC Class 1
Bearing Type	Angular Contact (Type A)
Seals, Shields	None (Open)
Unit System	Inch

**Load Capacities**

Static Radial Load	1,580 lbf
Dynamic Radial Load	615 lbf
Static Thrust Load	4,550 lbf
Dynamic Thrust Load	1,530 lbf

**Interchange**

Silverthin	<a href="#">SA042AR0</a>	Kaydon	<a href="#">KA042AR0</a>
SKF	<a href="#">FPAA404</a>	FAG	<a href="#">L15QA404</a>
SSB	<a href="#">RA042AR0</a>	RBC	<a href="#">KA042AR0*RBC</a>

**Brass; one piece pocket separator**

1/8" balls

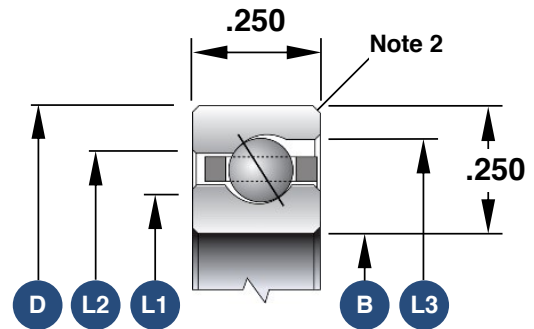

1. Load capacities are not additive
2. The maximum shaft or housing fillet radius that the bearing corners will clear for this series is 0.025"
3. Race Width Tolerance: +0.000 -0.005"

**Also Available**

Open Radial Contact	<a href="#">SA042CP0</a>
Open 4-Point Contact	<a href="#">SA042XP0</a>
Sealed Radial Contact	<a href="#">JSA042CP0</a>
Sealed 4-Point Contact	<a href="#">JSA042XP0</a>
Open Duplexed (Back-to-Back)	<a href="#">SA042BR0</a>
Open Duplexed (Face-to-Face)	<a href="#">SA042FR0</a>