

SILVERTHIN SA042CP0**4.25 in Open Type C Thin Section Bearing****Specifications**

Bore (B)	4.250 in
Outside Diameter (D)	4.750 in
Width	1/4"
Land Diameter (L ₁)	4.436 in
Land Diameter (L ₂)	4.564 in
Approximate Weight	0.20 lbs
Separator	Brass; snapover separator
Precision Class	ABEC Class 1
Bearing Type	Radial Contact (Type C)
Seals, Shields	None (Open)
Unit System	Inch

Load Capacities

Static Radial Load	1,370 lbf
Dynamic Radial Load	590 lbf

Interchange

Silverthin	SA042CP0	Kaydon	KA042CP0	Kaydon	KA042CP0	INA	CSCA042
SKF	FPCA404	FAG	L10QA404	NSK	NBC10706	NTN	KRA042
SSB	RA042CP0	RBC	KA042CP0*RBC				

Brass; snapover separator

1/8" balls

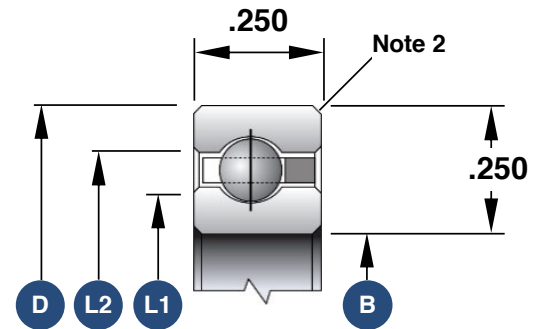

1. Load capacities are not additive
2. The maximum shaft or housing fillet radius that the bearing corners will clear for this series is 0.025"
3. Race Width Tolerance: +0.000 -0.005"

Also Available

Open Angular Contact	SA042AR0
Open 4-Point Contact	SA042XP0
Sealed Radial Contact	JSA042CP0
Sealed 4-Point Contact	JSA042XP0
Open Duplexed (Back-to-Back)	SA042BR0
Open Duplexed (Face-to-Face)	SA042FR0