

SILVERTHIN SA045CP0**4.5 in Open Type C Thin Section Bearing****Specifications**

Bore (B)	4.500 in
Outside Diameter (D)	5.000 in
Width	1/4"
Land Diameter (L ₁)	4.686 in
Land Diameter (L ₂)	4.814 in
Approximate Weight	0.22 lbs
Separator	Brass; snapover separator
Precision Class	ABEC Class 1
Bearing Type	Radial Contact (Type C)
Seals, Shields	None (Open)
Unit System	Inch

Load Capacities

Static Radial Load	1,440 lbf
Dynamic Radial Load	610 lbf

Interchange

Silverthin	SA045CP0	Kaydon	KA045CP0	Kaydon	KA045CP0	INA	CSCA045
SKF	FPCA408	FAG	L10QA408	NSK	NBC11406	NTN	KRA045
SSB	RA045CP0	RBC	KA045CP0*RBC				

Brass; snapover separator

1/8" balls

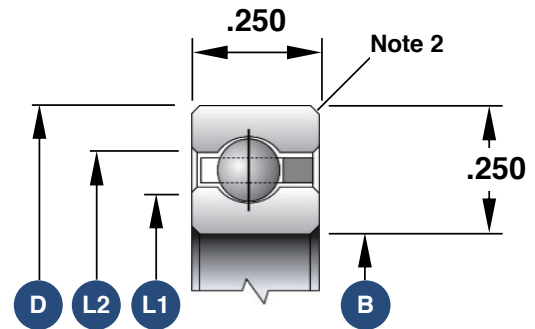

1. Load capacities are not additive
2. The maximum shaft or housing fillet radius that the bearing corners will clear for this series is 0.025"
3. Race Width Tolerance: +0.000 -0.005"

Also Available

Open Angular Contact	SA045AR0
Open 4-Point Contact	SA045XP0
Sealed Radial Contact	JSA045CP0
Sealed 4-Point Contact	JSA045XP0
Open Duplexed (Back-to-Back)	SA045BR0
Open Duplexed (Face-to-Face)	SA045FR0