

SILVERTHIN SA045XP0**4.5 in Open Type X Thin Section Bearing****Specifications**

Bore (B)	4.500 in
Outside Diameter (D)	5.000 in
Width	1/4"
Land Diameter (L ₁)	4.686 in
Land Diameter (L ₂)	4.814 in
Approximate Weight	0.22 lbs
Separator	Brass; snapover separator
Precision Class	ABEC Class 1
Bearing Type	4-Point Contact (Type X)
Seals, Shields	None (Open)
Unit System	Inch

Load Capacities

Static Radial Load	1,440 lbf
Dynamic Radial Load	810 lbf
Static Thrust Load	3,600 lbf
Dynamic Thrust Load	1,310 lbf
Static Moment Load	3,420 in-lbs
Dynamic Moment Load	1,440 in-lbs

Interchange

Silverthin	SA045XP0	Kaydon	KA045XP0	Kaydon	KA045XP0	INA	CSXA045
SKF	FPXA408	FAG	L18QA408	NSK	NBX11406	NTN	KXA045
SSB	RA045XP0	RBC	KA045XP0*RBC				

Brass; snapover separator

1/8" balls

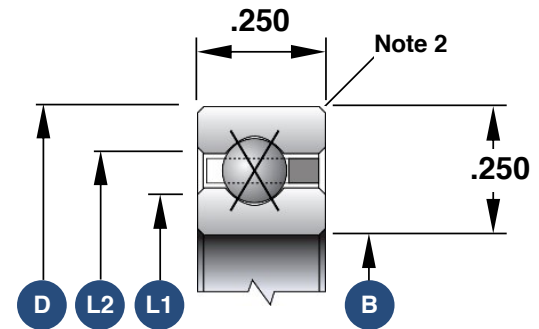

1. Load capacities are not additive
2. The maximum shaft or housing fillet radius that the bearing corners will clear for this series is 0.025"
3. Race Width Tolerance: +0.000 -0.005"

Also Available

Open Angular Contact	SA045AR0
Open Radial Contact	SA045CP0
Sealed Radial Contact	JSA045CP0
Sealed 4-Point Contact	JSA045XP0
Open Duplexed (Back-to-Back)	SA045BR0
Open Duplexed (Face-to-Face)	SA045FR0