

SILVERTHIN SA047AR0**4.75 in Open Type A Thin Section Bearing****Specifications**

Bore (B)	4.750 in
Outside Diameter (D)	5.250 in
Width	1/4"
Land Diameter (L ₁)	4.936 in
Land Diameter (L ₂)	5.064 in
Land Diameter (L ₃)	5.115 in
Approximate Weight	0.23 lbs
Separator	Brass; one piece pocket separator
Precision Class	ABEC Class 1
Bearing Type	Angular Contact (Type A)
Seals, Shields	None (Open)
Unit System	Inch

Load Capacities

Static Radial Load	1,750 lbf
Dynamic Radial Load	655 lbf
Static Thrust Load	5,060 lbf
Dynamic Thrust Load	1,640 lbf

Interchange

Silverthin	SA047AR0	Kaydon	KA047AR0	Kaydon	KA047AR0	INA	CSEA047
SKF	FPAA412	FAG	L15QA412	NSK	NBA12006	NTN	KYA047
SSB	RA047AR0	RBC	KA047AR0*RBC				

Brass; one piece pocket separator

1/8" balls

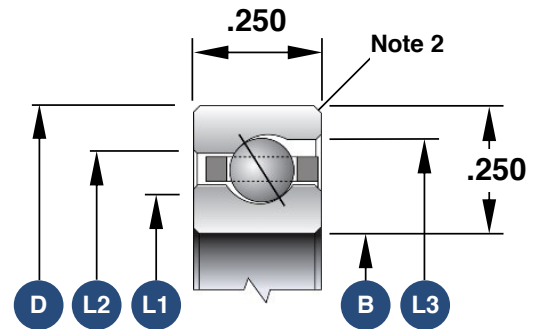

1. Load capacities are not additive
2. The maximum shaft or housing fillet radius that the bearing corners will clear for this series is 0.025"
3. Race Width Tolerance: +0.000 -0.005"

Also Available

Open Radial Contact	SA047CP0
Open 4-Point Contact	SA047XP0
Sealed Radial Contact	JSA047CP0
Sealed 4-Point Contact	JSA047XP0
Open Duplexed (Back-to-Back)	SA047BR0
Open Duplexed (Face-to-Face)	SA047FR0