

SILVERTHIN SA047CP0**4.75 in Open Type C Thin Section Bearing****Specifications**

Bore (B)	4.750 in
Outside Diameter (D)	5.250 in
Width	1/4"
Land Diameter (L ₁)	4.936 in
Land Diameter (L ₂)	5.064 in
Approximate Weight	0.23 lbs
Separator	Brass; snapover separator
Precision Class	ABEC Class 1
Bearing Type	Radial Contact (Type C)
Seals, Shields	None (Open)
Unit System	Inch

Load Capacities

Static Radial Load	1,520 lbf
Dynamic Radial Load	630 lbf

Interchange

Silverthin	SA047CP0	Kaydon	KA047CP0	Kaydon	KA047CP0	INA	CSCA047
SKF	FPCA412	FAG	L10QA412	NSK	NBC12006	NTN	KRA047
SSB	RA047CP0	RBC	KA047CP0*RBC				

Brass; snapover separator

1/8" balls

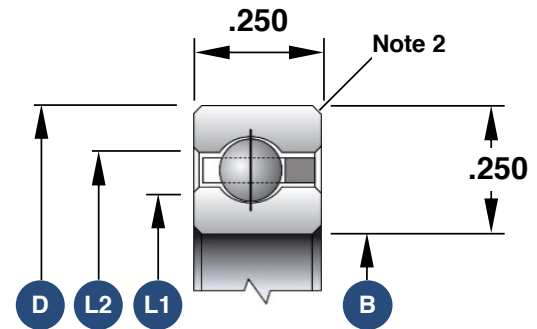

1. Load capacities are not additive
2. The maximum shaft or housing fillet radius that the bearing corners will clear for this series is 0.025"
3. Race Width Tolerance: +0.000 -0.005"

Also Available

Open Angular Contact	SA047AR0
Open 4-Point Contact	SA047XP0
Sealed Radial Contact	JSA047CP0
Sealed 4-Point Contact	JSA047XP0
Open Duplexed (Back-to-Back)	SA047BR0
Open Duplexed (Face-to-Face)	SA047FR0