

SILVERTHIN SA047XP0**4.75 in Open Type X Thin Section Bearing****Specifications**

Bore (B)	4.750 in
Outside Diameter (D)	5.250 in
Width	1/4"
Land Diameter (L ₁)	4.936 in
Land Diameter (L ₂)	5.064 in
Approximate Weight	0.23 lbs
Separator	Brass; snapover separator
Precision Class	ABEC Class 1
Bearing Type	4-Point Contact (Type X)
Seals, Shields	None (Open)
Unit System	Inch

Load Capacities

Static Radial Load	1,520 lbf
Dynamic Radial Load	835 lbf
Static Thrust Load	3,790 lbf
Dynamic Thrust Load	1,350 lbf
Static Moment Load	3,790 in-lbs
Dynamic Moment Load	1,565 in-lbs

Interchange

Silverthin	SA047XP0	Kaydon	KA047XP0	Kaydon	KA047XP0	INA	CSXA047
SKF	FPXA412	FAG	L18QA412	NSK	NBX12006	NTN	KXA047
SSB	RA047XP0	RBC	KA047XP0*RBC				

Brass; snapover separator

1/8" balls

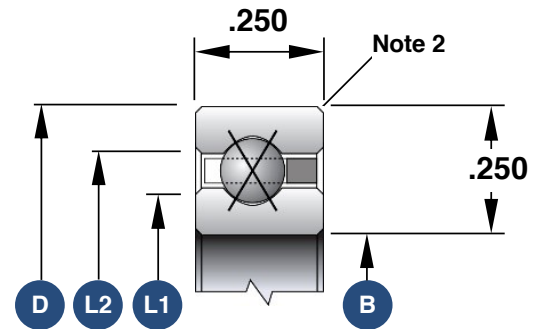

1. Load capacities are not additive
2. The maximum shaft or housing fillet radius that the bearing corners will clear for this series is 0.025"
3. Race Width Tolerance: +0.000 -0.005"

Also Available

Open Angular Contact	SA047AR0
Open Radial Contact	SA047CP0
Sealed Radial Contact	JSA047CP0
Sealed 4-Point Contact	JSA047XP0
Open Duplexed (Back-to-Back)	SA047BR0
Open Duplexed (Face-to-Face)	SA047FR0