

SILVERTHIN SA050AR0**5 in Open Type A Thin Section Bearing****Specifications**

Bore (B)	5.000 in
Outside Diameter (D)	5.500 in
Width	1/4"
Land Diameter (L ₁)	5.186 in
Land Diameter (L ₂)	5.314 in
Land Diameter (L ₃)	5.365 in
Approximate Weight	0.24 lbs
Separator	Brass; one piece pocket separator
Precision Class	ABEC Class 1
Bearing Type	Angular Contact (Type A)
Seals, Shields	None (Open)
Unit System	Inch

Load Capacities

Static Radial Load	1,840 lbf
Dynamic Radial Load	675 lbf
Static Thrust Load	5,310 lbf
Dynamic Thrust Load	1,690 lbf

Interchange

Silverthin	SA050AR0	Kaydon	KA050AR0	Kaydon	KA050AR0	INA	CSEA050
SKF	FPAA500	FAG	L15QA500	NSK	NBA12706	NTN	KYA050
SSB	RA050AR0	RBC	KA050AR0*RBC				

Brass; one piece pocket separator

1/8" balls

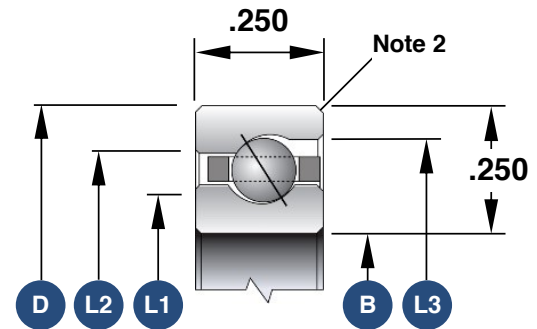

1. Load capacities are not additive
2. The maximum shaft or housing fillet radius that the bearing corners will clear for this series is 0.025"
3. Race Width Tolerance: +0.000 -0.005"

Also Available

Open Radial Contact	SA050CP0
Open 4-Point Contact	SA050XP0
Sealed Radial Contact	JSA050CP0
Sealed 4-Point Contact	JSA050XP0
Open Duplexed (Back-to-Back)	SA050BR0
Open Duplexed (Face-to-Face)	SA050FR0