

SILVERTHIN SA050CPO**5 in Open Type C Thin Section Bearing****Specifications**

Bore (B)	5.000 in
Outside Diameter (D)	5.500 in
Width	1/4"
Land Diameter (L ₁)	5.186 in
Land Diameter (L ₂)	5.314 in
Approximate Weight	0.24 lbs
Separator	Brass; snapover separator
Precision Class	ABEC Class 1
Bearing Type	Radial Contact (Type C)
Seals, Shields	None (Open)
Unit System	Inch

Load Capacities

Static Radial Load	1,590 lbf
Dynamic Radial Load	650 lbf

Interchange

Silverthin	SA050CPO	Kaydon	KA050CPO	Kaydon	KA050CPO	INA	CSCA050
SKF	FPCA500	FAG	L10QA500	NSK	NBC12706	NTN	KRA050
SSB	RA050CPO	RBC	KA050CPO*RBC				

Brass; snapover separator

1/8" balls

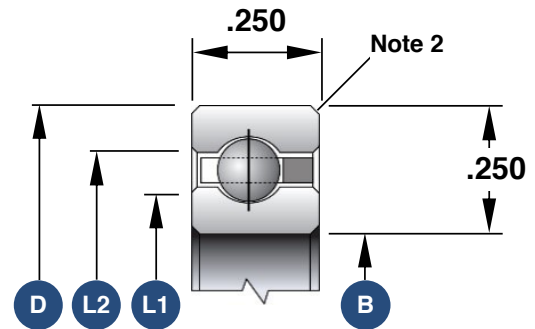

1. Load capacities are not additive
2. The maximum shaft or housing fillet radius that the bearing corners will clear for this series is 0.025"
3. Race Width Tolerance: +0.000 -0.005"

Also Available

Open Angular Contact	SA050ARO
Open 4-Point Contact	SA050XPO
Sealed Radial Contact	JSA050CPO
Sealed 4-Point Contact	JSA050XPO
Open Duplexed (Back-to-Back)	SA050BR0
Open Duplexed (Face-to-Face)	SA050FR0