

SILVERTHIN SA055AR0**5.5 in Open Type A Thin Section Bearing****Specifications**

Bore (B)	5.500 in
Outside Diameter (D)	6.000 in
Width	1/4"
Land Diameter (L ₁)	5.686 in
Land Diameter (L ₂)	5.814 in
Land Diameter (L ₃)	5.863 in
Approximate Weight	0.25 lbs
Separator	Brass; one piece pocket separator
Precision Class	ABEC Class 1
Bearing Type	Angular Contact (Type A)
Seals, Shields	None (Open)
Unit System	Inch

Load Capacities

Static Radial Load	2,020 lbf
Dynamic Radial Load	715 lbf
Static Thrust Load	5,820 lbf
Dynamic Thrust Load	1,800 lbf

Interchange

Silverthin	SA055AR0	Kaydon	KA055AR0	Kaydon	KA055AR0	INA	CSEA055
SKF	FPAA508	FAG	L15QA508	NSK	NBA13906	NTN	KYA055
SSB	RA055AR0	RBC	KA055AR0*RBC				

Brass; one piece pocket separator

1/8" balls

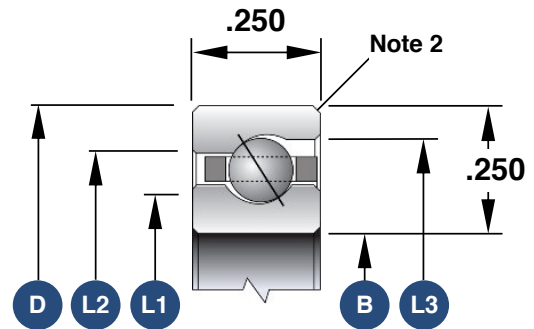

1. Load capacities are not additive
2. The maximum shaft or housing fillet radius that the bearing corners will clear for this series is 0.025"
3. Race Width Tolerance: +0.000 -0.005"

Also Available

Open Radial Contact	SA055CP0
Open 4-Point Contact	SA055XP0
Sealed Radial Contact	JSA055CP0
Sealed 4-Point Contact	JSA055XP0
Open Duplexed (Back-to-Back)	SA055BR0
Open Duplexed (Face-to-Face)	SA055FR0