

**SILVERTHIN SA055CP0****5.5 in Open Type C Thin Section Bearing****Specifications**

Bore (B)	5.500 in
Outside Diameter (D)	6.000 in
Width	1/4"
Land Diameter (L <sub>1</sub> )	5.686 in
Land Diameter (L <sub>2</sub> )	5.814 in
Approximate Weight	0.25 lbs
Separator	Brass; snapover separator
Precision Class	ABEC Class 1
Bearing Type	Radial Contact (Type C)
Seals, Shields	None (Open)
Unit System	Inch

**Load Capacities**

Static Radial Load	1,750 lbf
Dynamic Radial Load	685 lbf

**Interchange**

Silverthin	<a href="#">SA055CP0</a>	Kaydon	<a href="#">KA055CP0</a>	Kaydon	<a href="#">KA055CP0</a>	INA	<a href="#">CSCA055</a>
SKF	<a href="#">FPCA508</a>	FAG	<a href="#">L10QA508</a>	NSK	<a href="#">NBC13906</a>	NTN	<a href="#">KRA055</a>
SSB	<a href="#">RA055CP0</a>	RBC	<a href="#">KA055CP0*RBC</a>				

**Brass; snapover separator**

1/8" balls

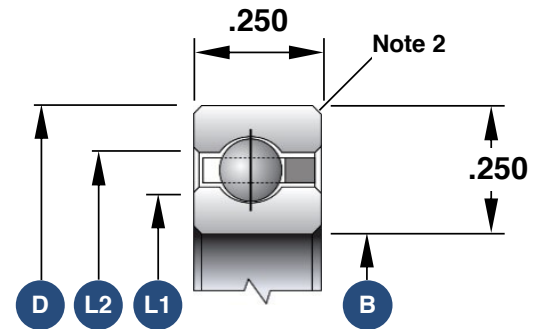

1. Load capacities are not additive
2. The maximum shaft or housing fillet radius that the bearing corners will clear for this series is 0.025"
3. Race Width Tolerance: +0.000 -0.005"

**Also Available**

Open Angular Contact	<a href="#">SA055AR0</a>
Open 4-Point Contact	<a href="#">SA055XP0</a>
Sealed Radial Contact	<a href="#">JSA055CP0</a>
Sealed 4-Point Contact	<a href="#">JSA055XP0</a>
Open Duplexed (Back-to-Back)	<a href="#">SA055BR0</a>
Open Duplexed (Face-to-Face)	<a href="#">SA055FR0</a>