

SILVERTHIN SA055XPO**5.5 in Open Type X Thin Section Bearing****Specifications**

Bore (B)	5.500 in
Outside Diameter (D)	6.000 in
Width	1/4"
Land Diameter (L ₁)	5.686 in
Land Diameter (L ₂)	5.814 in
Approximate Weight	0.25 lbs
Separator	Brass; snapover separator
Precision Class	ABEC Class 1
Bearing Type	4-Point Contact (Type X)
Seals, Shields	None (Open)
Unit System	Inch

Load Capacities

Static Radial Load	1,750 lbf
Dynamic Radial Load	910 lbf
Static Thrust Load	4,360 lbf
Dynamic Thrust Load	1,480 lbf
Static Moment Load	5,020 in-lbs
Dynamic Moment Load	1,960 in-lbs

Interchange

Silverthin	SA055XPO	Kaydon	KA055XPO	Kaydon	KA055XPO	INA	CSXA055
SKF	FPXA508	FAG	L18QA508	NSK	NBX13906	NTN	KXA055
SSB	RA055XPO	RBC	KA055XPO*RBC				

Brass; snapover separator

1/8" balls

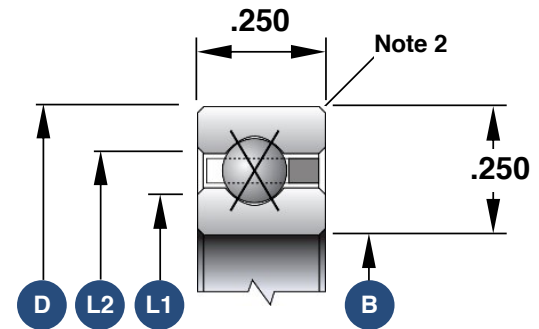

1. Load capacities are not additive
2. The maximum shaft or housing fillet radius that the bearing corners will clear for this series is 0.025"
3. Race Width Tolerance: +0.000 -0.005"

Also Available

Open Angular Contact	SA055AR0
Open Radial Contact	SA055CP0
Sealed Radial Contact	JSA055CP0
Sealed 4-Point Contact	JSA055XPO
Open Duplexed (Back-to-Back)	SA055BR0
Open Duplexed (Face-to-Face)	SA055FR0