

SILVERTHIN SA060AR0**6 in Open Type A Thin Section Bearing****Specifications**

Bore (B)	6.000 in
Outside Diameter (D)	6.500 in
Width	1/4"
Land Diameter (L ₁)	6.186 in
Land Diameter (L ₂)	6.314 in
Land Diameter (L ₃)	6.363 in
Approximate Weight	0.28 lbs
Separator	Brass; one piece pocket separator
Precision Class	ABEC Class 1
Bearing Type	Angular Contact (Type A)
Seals, Shields	None (Open)
Unit System	Inch

Load Capacities

Static Radial Load	2,190 lbf
Dynamic Radial Load	750 lbf
Static Thrust Load	6,320 lbf
Dynamic Thrust Load	1,900 lbf

Interchange

Silverthin	SA060AR0	Kaydon	KA060AR0	Kaydon	KA060AR0	INA	CSEA060
SKF	FPAA600	FAG	L15QA600	NSK	NBA15206	NTN	KYA060
SSB	RA060AR0	RBC	KA060AR0*RBC				

Brass; one piece pocket separator

1/8" balls

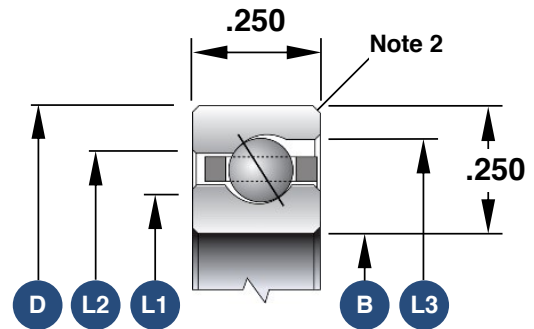

1. Load capacities are not additive
2. The maximum shaft or housing fillet radius that the bearing corners will clear for this series is 0.025"
3. Race Width Tolerance: +0.000 -0.005"

Also Available

Open Radial Contact	SA060CP0
Open 4-Point Contact	SA060XP0
Sealed Radial Contact	JSA060CP0
Sealed 4-Point Contact	JSA060XP0
Open Duplexed (Back-to-Back)	SA060BR0
Open Duplexed (Face-to-Face)	SA060FR0