

SILVERTHIN SA060CP0**6 in Open Type C Thin Section Bearing****Specifications**

Bore (B)	6.000 in
Outside Diameter (D)	6.500 in
Width	1/4"
Land Diameter (L ₁)	6.186 in
Land Diameter (L ₂)	6.314 in
Approximate Weight	0.28 lbs
Separator	Brass; snapover separator
Precision Class	ABEC Class 1
Bearing Type	Radial Contact (Type C)
Seals, Shields	None (Open)
Unit System	Inch

Load Capacities

Static Radial Load	1,900 lbf
Dynamic Radial Load	720 lbf

Interchange

Silverthin	SA060CP0	Kaydon	KA060CP0	Kaydon	KA060CP0	INA	CSCA060
SKF	FPCA600	FAG	L10QA600	NSK	NBC15206	NTN	KRA060
SSB	RA060CP0	RBC	KA060CP0*RBC				

Brass; snapover separator

1/8" balls

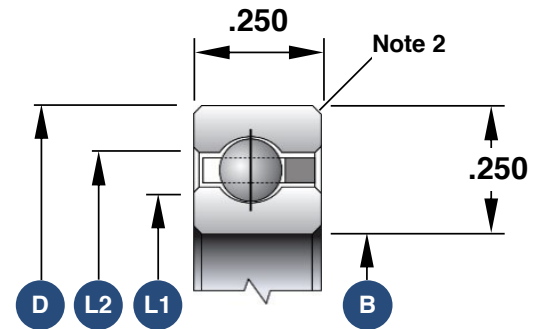

1. Load capacities are not additive
2. The maximum shaft or housing fillet radius that the bearing corners will clear for this series is 0.025"
3. Race Width Tolerance: +0.000 -0.005"

Also Available

Open Angular Contact	SA060ARO
Open 4-Point Contact	SA060XPO
Sealed Radial Contact	JSA060CP0
Sealed 4-Point Contact	JSA060XPO
Open Duplexed (Back-to-Back)	SA060BR0
Open Duplexed (Face-to-Face)	SA060FR0