

SILVERTHIN SA060XP0**6 in Open Type X Thin Section Bearing****Specifications**

Bore (B)	6.000 in
Outside Diameter (D)	6.500 in
Width	1/4"
Land Diameter (L ₁)	6.186 in
Land Diameter (L ₂)	6.314 in
Approximate Weight	0.28 lbs
Separator	Brass; snapover separator
Precision Class	ABEC Class 1
Bearing Type	4-Point Contact (Type X)
Seals, Shields	None (Open)
Unit System	Inch

Load Capacities

Static Radial Load	1,900 lbf
Dynamic Radial Load	955 lbf
Static Thrust Load	4,740 lbf
Dynamic Thrust Load	1,570 lbf
Static Moment Load	5,930 in-lbs
Dynamic Moment Load	2,240 in-lbs

Interchange

Silverthin	SA060XP0	Kaydon	KA060XP0	Kaydon	KA060XP0	INA	CSXA060
SKF	FPXA600	FAG	L18QA600	NSK	NBX15206	NTN	KXA060
SSB	RA060XP0	RBC	KA060XP0*RBC				

Brass; snapover separator

1/8" balls

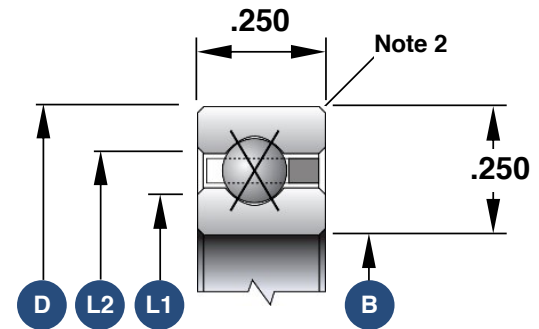

1. Load capacities are not additive
2. The maximum shaft or housing fillet radius that the bearing corners will clear for this series is 0.025"
3. Race Width Tolerance: +0.000 -0.005"

Also Available

Open Angular Contact	SA060AR0
Open Radial Contact	SA060CP0
Sealed Radial Contact	JSA060CP0
Sealed 4-Point Contact	JSA060XP0
Open Duplexed (Back-to-Back)	SA060BR0
Open Duplexed (Face-to-Face)	SA060FR0