

**SILVERTHIN SA065AR0****6.5 in Open Type A Thin Section Bearing****Specifications**

Bore (B)	6.500 in
Outside Diameter (D)	7.000 in
Width	1/4"
Land Diameter (L <sub>1</sub> )	6.686 in
Land Diameter (L <sub>2</sub> )	6.814 in
Land Diameter (L <sub>3</sub> )	6.861 in
Approximate Weight	0.30 lbs
Separator	Brass; one piece pocket separator
Precision Class	ABEC Class 1
Bearing Type	Angular Contact (Type A)
Seals, Shields	None (Open)
Unit System	Inch

**Load Capacities**

Static Radial Load	2,370 lbf
Dynamic Radial Load	790 lbf
Static Thrust Load	6,830 lbf
Dynamic Thrust Load	2,000 lbf

**Interchange**

Silverthin	<a href="#">SA065AR0</a>	Kaydon	<a href="#">KA065AR0</a>	Kaydon	<a href="#">KA065AR0</a>	INA	<a href="#">CSEA065</a>
SKF	<a href="#">FPAA608</a>	FAG	<a href="#">L15QA608</a>	NSK	<a href="#">NBA16506</a>	NTN	<a href="#">KYA065</a>
SSB	<a href="#">RA065AR0</a>	RBC	<a href="#">KA065AR0*RBC</a>				

**Brass; one piece pocket separator**

1/8" balls

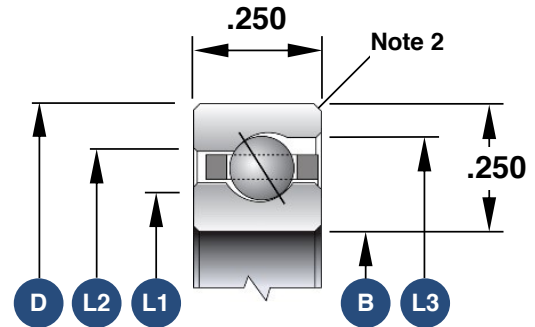

1. Load capacities are not additive
2. The maximum shaft or housing fillet radius that the bearing corners will clear for this series is 0.025"
3. Race Width Tolerance: +0.000 -0.005"

**Also Available**

Open Radial Contact	<a href="#">SA065CP0</a>
Open 4-Point Contact	<a href="#">SA065XP0</a>
Sealed Radial Contact	<a href="#">JSA065CP0</a>
Sealed 4-Point Contact	<a href="#">JSA065XP0</a>
Open Duplexed (Back-to-Back)	<a href="#">SA065BR0</a>
Open Duplexed (Face-to-Face)	<a href="#">SA065FR0</a>