

SILVERTHIN SA065CP0**6.5 in Open Type C Thin Section Bearing****Specifications**

Bore (B)	6.500 in
Outside Diameter (D)	7.000 in
Width	1/4"
Land Diameter (L ₁)	6.686 in
Land Diameter (L ₂)	6.814 in
Approximate Weight	0.30 lbs
Separator	Brass; snapover separator
Precision Class	ABEC Class 1
Bearing Type	Radial Contact (Type C)
Seals, Shields	None (Open)
Unit System	Inch

Load Capacities

Static Radial Load	2,050 lbf
Dynamic Radial Load	755 lbf

Interchange

Silverthin	SA065CP0	Kaydon	KA065CP0	Kaydon	KA065CP0	INA	CSCA065
SKF	FPCA608	FAG	L10QA608	NSK	NBC16506	NTN	KRA065
SSB	RA065CP0	RBC	KA065CP0*RBC				

Brass; snapover separator

1/8" balls

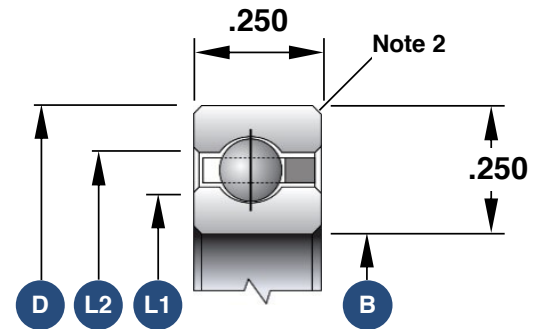

1. Load capacities are not additive
2. The maximum shaft or housing fillet radius that the bearing corners will clear for this series is 0.025"
3. Race Width Tolerance: +0.000 -0.005"

Also Available

Open Angular Contact	SA065AR0
Open 4-Point Contact	SA065XP0
Sealed Radial Contact	JSA065CP0
Sealed 4-Point Contact	JSA065XP0
Open Duplexed (Back-to-Back)	SA065BR0
Open Duplexed (Face-to-Face)	SA065FR0