

SILVERTHIN SA065XPO**6.5 in Open Type X Thin Section Bearing****Specifications**

Bore (B)	6.500 in
Outside Diameter (D)	7.000 in
Width	1/4"
Land Diameter (L ₁)	6.686 in
Land Diameter (L ₂)	6.814 in
Approximate Weight	0.30 lbs
Separator	Brass; snapover separator
Precision Class	ABEC Class 1
Bearing Type	4-Point Contact (Type X)
Seals, Shields	None (Open)
Unit System	Inch

Load Capacities

Static Radial Load	2,050 lbf
Dynamic Radial Load	1,000 lbf
Static Thrust Load	5,120 lbf
Dynamic Thrust Load	1,650 lbf
Static Moment Load	6,910 in-lbs
Dynamic Moment Load	2,535 in-lbs

Interchange

Silverthin	SA065XPO	Kaydon	KA065XPO	Kaydon	KA065XPO	INA	CSXA065
SKF	FPXA608	FAG	L18QA608	NSK	NBX16506	NTN	KXA065
SSB	RA065XPO	RBC	KA065XPO*RBC				

Brass; snapover separator

1/8" balls

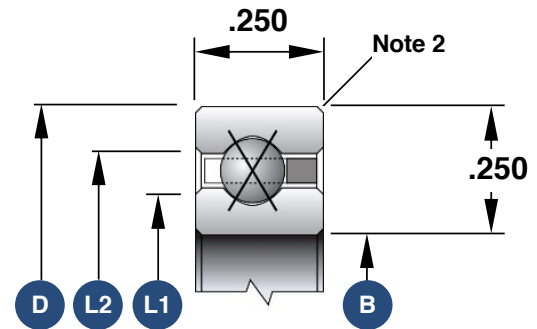

1. Load capacities are not additive
2. The maximum shaft or housing fillet radius that the bearing corners will clear for this series is 0.025"
3. Race Width Tolerance: +0.000 -0.005"

Also Available

Open Angular Contact	SA065AR0
Open Radial Contact	SA065CP0
Sealed Radial Contact	JSA065CP0
Sealed 4-Point Contact	JSA065XPO
Open Duplexed (Back-to-Back)	SA065BR0
Open Duplexed (Face-to-Face)	SA065FR0