

**SILVERTHIN SA070AR0****7 in Open Type A Thin Section Bearing****Specifications**

Bore (B)	7.000 in
Outside Diameter (D)	7.500 in
Width	1/4"
Land Diameter (L <sub>1</sub> )	7.186 in
Land Diameter (L <sub>2</sub> )	7.314 in
Land Diameter (L <sub>3</sub> )	7.361 in
Approximate Weight	0.31 lbs
Separator	Brass; one piece pocket separator
Precision Class	ABEC Class 1
Bearing Type	Angular Contact (Type A)
Seals, Shields	None (Open)
Unit System	Inch

**Load Capacities**

Static Radial Load	2,540 lbf
Dynamic Radial Load	825 lbf
Static Thrust Load	7,340 lbf
Dynamic Thrust Load	2,100 lbf

**Interchange**

Silverthin	<b>SA070AR0</b>	Kaydon	<b>KA070AR0</b>
SKF	<b>FPAA700</b>	FAG	<b>L15QA700</b>
SSB	<b>RA070AR0</b>	RBC	<b>KA070AR0*RBC</b>

**Brass; one piece pocket separator**

1/8" balls

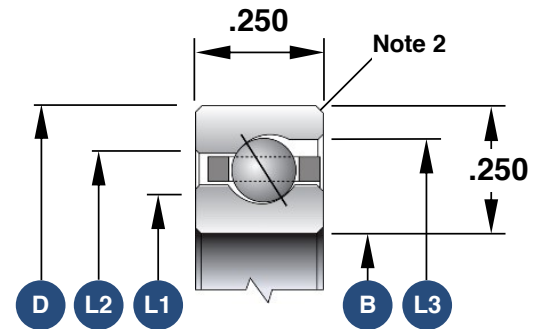

1. Load capacities are not additive
2. The maximum shaft or housing fillet radius that the bearing corners will clear for this series is 0.025"
3. Race Width Tolerance: +0.000 -0.005"

**Also Available**

Open Radial Contact	<b>SA070CP0</b>
Open 4-Point Contact	<b>SA070XP0</b>
Open Duplexed (Back-to-Back)	<b>SA070BR0</b>
Open Duplexed (Face-to-Face)	<b>SA070FR0</b>